



ADDENDUM NO. 1

Greater New Haven Water Pollution Control Authority

2017 Collection System Assessment and Rehabilitation –
Wall Street Project
Project No. SSR 2017-03

TO: ALL PLAN HOLDERS
DATE: April 21, 2017

This addendum shall be attached to the Contract Documents by each bidder. Each bidder shall acknowledge receipt of this Addendum by entering the Addendum number and date received in the space provided in **Section §102-20 Itemized Proposal**.

The Specifications and Contract Documents are hereby modified as follows:

1. Modification to Section §102-20 Itemized Proposal

Project completion date is August 30, 2017.

2. Modification to Section §102-20 Itemized Proposal

Replace Schedule of Bid Items with the enclosed pages.

The 15" sewers on Wall Street between High Street and College Street have been removed from the Bid.

East Ramsdell Street has been added to the lining contract. The length of sewer to be rehabilitated on East Ramsdell Street is 484 LF of 12" VCP pipe.

3. Modifications to Appendix D. Schedule of Sewers to be Rehabilitated

Replace existing schedule with the enclosed schedule revised 4/21/2017.

4. Modifications to Appendix E. Contract Drawings

Replace Sheet No. 1 with the enclosed drawing revised 4/21/2017. Add the enclosed Sheet No. 8 to the Contract Documents.

Project No. SSR 2017-03 provided for questions or requests for clarification to be received in writing by the Authority through April 21, 2017 at 12:00 PM. The following is provided in response to questions received.

Questions submitted by Michael Cronin, Insituform Technologies

1. Does the City know what degree the two bends are in the 18" line from MH 180 to 181?
Response: No
2. Would the contractor be able to install a new man hole at the intersection of Wall and Church St for lining purposes?
Response: No. If it becomes necessary the Authority will install a sanitary sewer manhole for access using the on-call emergency Contractor (CJ Fucci).
3. Is the project tax exempt?
Response: Yes.
4. Are TV inspection logs available?
Response: There are no available videos.
5. What are the work hours allowed?
Response: Contractor shall follow the City's Ordinance and requirements. The City allows work between 7am and 7pm. Any other times of work shall be as approved by the City.
6. What are the manhole depths?
Response: Please refer to the contract drawings. All manholes show the unique manhole ID, rim elevation and invert elevation.

- END OF ADDENDUM No. 1 -

**ADDENDUM No. 1 ISSUED BY:
GREATER NEW HAVEN WATER POLLUTION CONTROL AUTHORITY**

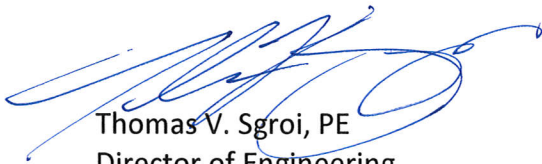

Thomas V. Sgroi, PE
Director of Engineering



Schedule Of Bid Items

ITEM NUMBER	ESTIMATED QUANTITY	UNIT	ITEM WITH UNIT PRICE WRITTEN IN WORDS	UNIT BID PRICE		AMOUNT BID	
				DOLLARS	CTS	DOLLARS	CTS
205	30	CY	Cubic Yard Trench Excavation and Backfill For - _____ _____	_____	_____	_____	_____
407	50	SY	Square Yard Bituminous Concrete Trench Repair Class 2, Thickness 4 inches For - _____ _____	_____	_____	_____	_____
516	1	LS	Lump Sum Sanitary Sewer Flow Control and Bypass Pumping For - _____ _____	_____	_____	_____	_____
518.01.6	2013	LF	Linear Foot Sanitary Sewer Hydraulic Cleaning (Light) 18" Cement/VCP/Clay Pipe For - _____ _____	_____	_____	_____	_____
518.01.7	563	LF	Linear Foot Sanitary Sewer Hydraulic Cleaning (Light) 15" Cement/VCP/Clay Pipe For - _____ _____	_____	_____	_____	_____
518.01.8	1806	LF	Linear Foot Sanitary Sewer Hydraulic Cleaning (Light) 12" Cement/VCP/Clay Pipe For - _____ _____	_____	_____	_____	_____
520.01.6	2013	LF	Linear Foot 18" Sanitary Sewer CIPP Lining For - _____ _____	_____	_____	_____	_____



Schedule Of Bid Items

ITEM NUMBER	ESTIMATED QUANTITY	UNIT	ITEM WITH UNIT PRICE WRITTEN IN WORDS	UNIT BID PRICE		AMOUNT BID	
				DOLLARS	CTS	DOLLARS	CTS
520.01.7	563	LF	Linear Foot 15" Sanitary Sewer CIPP Lining For - _____ _____	_____	_____	_____	_____
520.01.8	1806	LF	Linear Foot 12" Sanitary Sewer CIPP Lining For - _____ _____	_____	_____	_____	_____
520.10	107	EA	Each Re-establish House Service Connections For - _____ _____	_____	_____	_____	_____
520.11.1	20	EA	Each Cut Protruding (Clay/Plastic) Taps For - _____ _____	_____	_____	_____	_____
520.11.2	10	EA	Each Cut Protruding (Concrete) Taps For - _____ _____	_____	_____	_____	_____
520.11.3	10	EA	Each Cut Protruding (DI/CI) Taps For - _____ _____	_____	_____	_____	_____
522.06	2013	LF	Linear Foot Sanitary Sewer CCTV Inspection, 18" Sewer For - _____ _____	_____	_____	_____	_____



Schedule Of Bid Items

ITEM NUMBER	ESTIMATED QUANTITY	UNIT	ITEM WITH UNIT PRICE WRITTEN IN WORDS	UNIT BID PRICE		AMOUNT BID	
				DOLLARS	CTS	DOLLARS	CTS
522.07	563	LF	Linear Foot Sanitary Sewer CCTV Inspection, 15" Sewer For - _____ _____	_____	_____	_____	_____
522.08	1806	LF	Linear Foot Sanitary Sewer CCTV Inspection, 12" Sewer For - _____ _____	_____	_____	_____	_____
971	1	LS	Lump Sum Maintenance and Protection of Traffic For - _____ _____	_____	_____	_____	_____
971.01	1	All	Allowance Traffic Men For - Fifty Five Thousand Dollars and No Cents _____	\$ 55,000	. 00	\$ 55,000	. 00
975	1	LS	Lump Sum Mobilization (Max. 3% of Total Cost) For - _____ _____	_____	_____	_____	_____
BASE BID TOTAL OR GROSS SUM IN WORDS: _____						\$ _____	IN FIGURES _____

Signature of Bidder: _____ Dated: _____

Printed Name: _____

Name of Firm: _____

SSR 2017-03 : Schedule of Sewers to be Cleaned, CCTV Inspected and Rehabilitated

Street	Upstream Manhole	Downstream Manhole	Cleaning	CCTV	CIPP	Diameter (in)	Length (lf)	No. laterals	Sheet Number
WALL	NUNO2M0635	NUNO2M0636	X	X	X	15	245	12	1
WALL	NUNO2M0636	NUNO2M0637	X	X	X	15	203	7	1
WALL	NUNO2M0637	NUNO2M0638	X	X	X	18	31	0	1
WALL	NUNO2M0180	NUNO2M0181	X	X	X	18	295	5	2
WALL	NUNO2M0181	CHURCH	X	X		18	104	3	2
WALL	NUNO2M0183	CHURCH	X	X		15	206	3	2
WALL	NUNO2M0182	NUNO2M0183	X	X	X	15	204	3	2
CROWN	NUNO4M0694	NUNO4M0759	X	X	X	18	194	3	3
CROWN	NUNO4M0759	NUNO4M0745	X	X	X	18	181	6	3
CROWN	NUNO4M0745	NUNO4M0746	X	X	X	18	165	3	3
CROWN	NUNO4M0746	NUNO4M0872	X	X	X	18	165	5	3
CROWN	NUNO4M0872	NUNO4M0873	X	X	X	18	153	3	3
CROWN	NUNO4M0873	NUNO4M0874	X	X	X	18	21	0	3
CROWN	NUNO4M0708	NUNO4M0709	X	X	X	18	132	3	4
CROWN	NUNO4M0709	NUNO4M0710	X	X	X	18	125	3	4
PECK	NFH01M0356	NFH01M0120	X	X	X	12	183	3	5
PECK	NFH01M0120	NFH01M0121	X	X	X	12	172	6	5
PECK	NFH01M0121	NFH01M0122	X	X	X	12	165	6	5
PECK	NFH01M0122	NFH01M0123	X	X	X	12	170	6	5
PECK	NFH01M0123	NFH01M0124	X	X	X	12	61	1	5
PECK	NFH01M0124	NFH01M0119	X	X	X	12	231	5	5
PECK	NFH01M0119	NFH01M0107	X	X	X	12	33	0	5
FERRY	NFH01M0345	NFH01M0346	X	X	X	15	152	5	6
SARGENT DR	NBL03M0219	NBL03M0204	X	X	X	12	307	2	7
EAST RAMSDELL	NWR02M0672	NWR02M0673	X	X	X	12	201	0	8
EAST RAMSDELL	NWR02M0673	NWR02M0674	X	X	X	12	64	0	8
EAST RAMSDELL	NWR02M0674	NWR02M0668	X	X	X	12	11	0	8
EAST RAMSDELL	NWR02M0668	NWR02M0669	X	X	X	15	42	0	8
EAST RAMSDELL	NWR02M0669	NWR02M0664	X	X	X	12	166	0	8

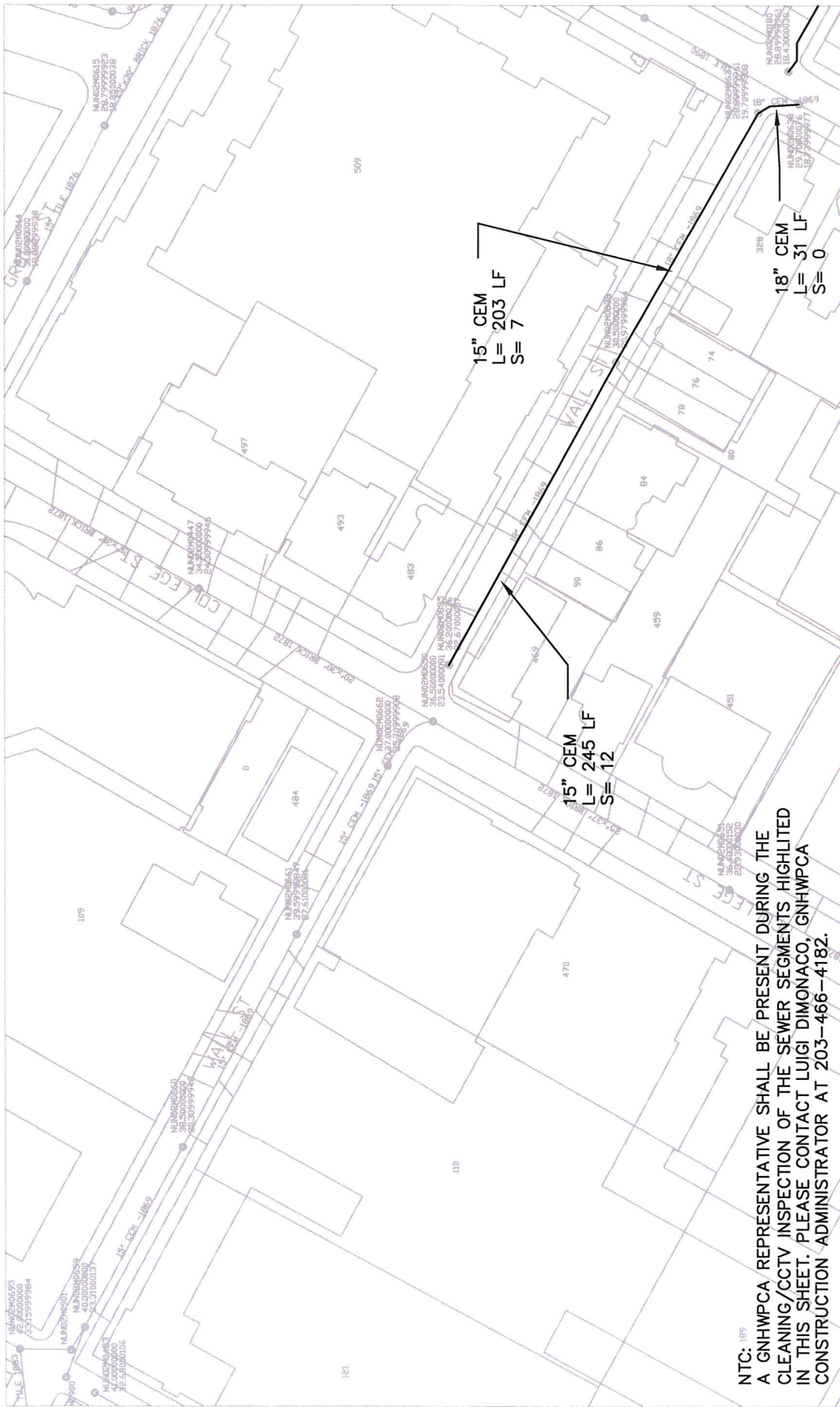

NTC: 189
 A GNHWPCA REPRESENTATIVE SHALL BE PRESENT DURING THE
 CLEANING/CCTV INSPECTION OF THE SEWER SEGMENTS HIGHLIGHTED
 IN THIS SHEET. PLEASE CONTACT LUIGI DIMONACO, GNHWPCA
 CONSTRUCTION ADMINISTRATOR AT 203-466-4182.

PLAN
 1" = 100'

LEGEND

L= LINEAR FEET OF PIPE
 S= No. OF SERVICE LATERALS PRESENT

Greater New Haven Water Pollution Control Authority
 ENGINEERING DEPARTMENT
 260 East Street
 New Haven, CT 06511
 (203) 466 5280 p (203) 722-1564 f



Drawn By: RC | Approved By: TS | Date: 4/21/2017

2017 COLLECTION SYSTEM
 ASSESSMENT AND REHABILITATION -
 WALL STREET PROJECT

Project No.: SSR 2017-03 | Sheet No.: 1 of

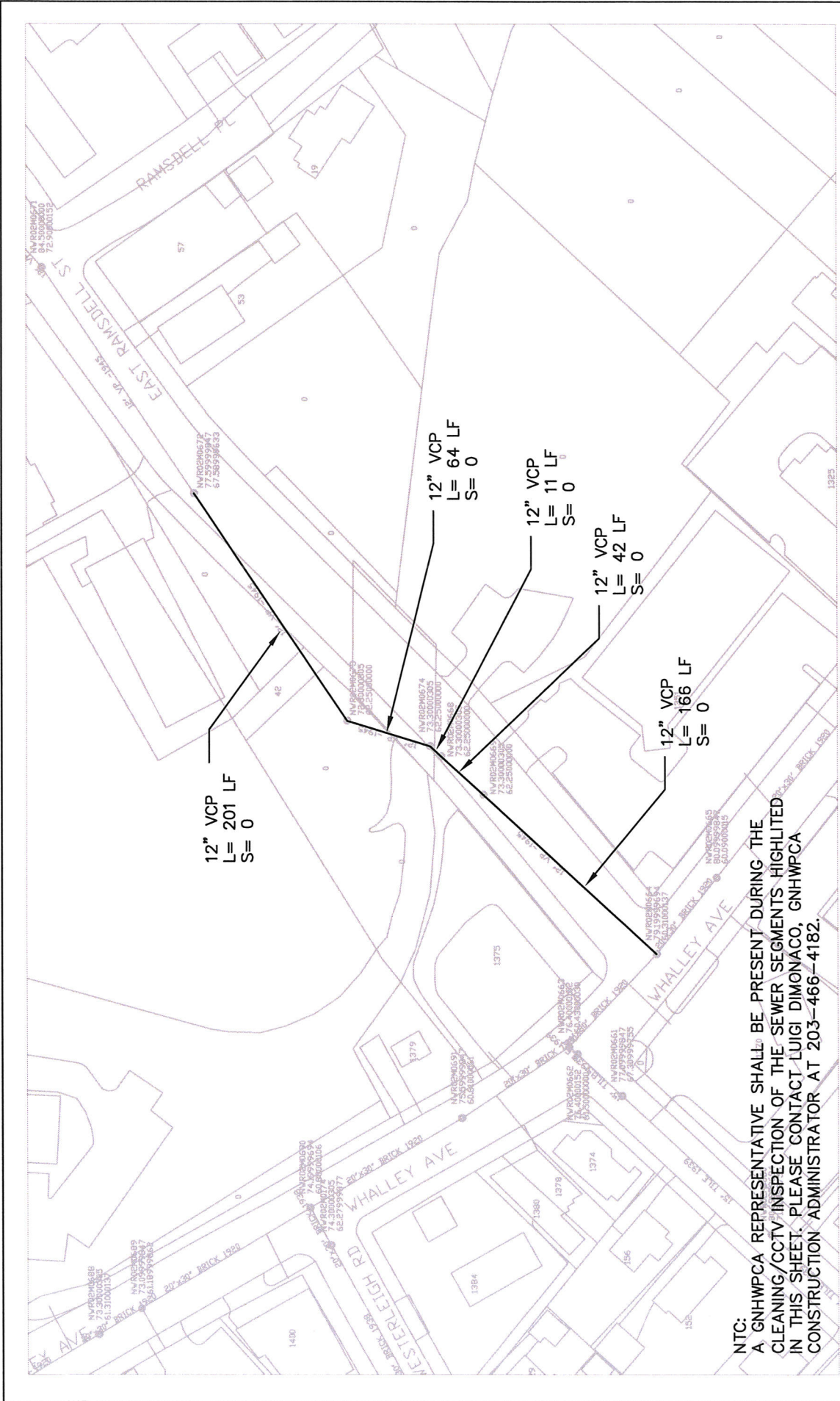

NTC:
 A GNHWPCA REPRESENTATIVE SHALL BE PRESENT DURING THE
 CLEANING/CCTV INSPECTION OF THE SEWER SEGMENTS HIGHLIGHTED
 IN THIS SHEET. PLEASE CONTACT LUIGI DIMONACO, GNHWPCA
 CONSTRUCTION ADMINISTRATOR AT 203-466-4182.

Greater New Haven Water Pollution Control Authority
 ENGINEERING DEPARTMENT
 260 East Street
 New Haven, CT 06511
 (203) 466 5280 p (203) 722-1664 f

Drawn By: RC Approved By: TS Date: 4/13/2017

2017 COLLECTION SYSTEM
 ASSESSMENT AND REHABILITATION -
 WALL STREET PROJECT

Project No.: SSR 2017-03 Sheet No.: 8 of



PLAN
 1" = 100'

LEGEND

L= LINEAR FEET OF PIPE
 S= No. OF SERVICE LATERALS PRESENT