

GNHWPCA
New Haven Pump Stations
Resiliency Improvement Project:

ADDENDUM NO. 2

To be considered as part of the contract drawings and specifications for the GNHWPCA New Haven Pump Station Resiliency Improvement Project dated November 4, 2019.

SPECIFICATIONS

See responses to questions for additional clarifications and modifications to the Contract documents.

Bid Package

DELETE Bid Package dated 11/20/2019 in its entirety, and REPLACE with the Bid Package dated 12/9/2019, which is appended to this Addendum No. 2.

DELETE Sections 00410 and 00420 and REPLACE with Sections 00410 and 00420 included in the attached Bid Package.

Section 01270 – Measurement and Payment

DELETE Section 01270 in its entirety and REPLACE with Section 01270, which is appended to this Addendum.

Section 08100 – Metal Doors and Frames

DELETE Section 08100 in its entirety.

Add the following new technical specifications to the Contract Documents:

Section 11312 – Sump Pumps

Section 08533 - Vinyl Window

Section 08163 - Fiberglass Reinforced Door and Door Frame Systems

DRAWINGS

See responses to questions for additional clarifications and modifications to the Contract documents.

Drawing R001:

Delete all references to wall dimensions and insert the following note. "7. For wall dimensions, see drawing S002.

Insert the following note:

8. Contractor shall use the following rough opening window dimensions for all proposed Fixed Solid Metal Panels, Access Hatch Replacement, and Windowpane Replacement shown on sheet R001. Contractor shall field verify all dimensions prior to shop drawing submittal, as stated in note 2 of this sheet. Each building has a standard window size.
 - Building A: (Operations Building) (3 EA) = 40" wide x 28" high
 - Building B - (7 EA) = 48" wide x 40" high
 - Building C - (1 EA) = 56" wide x 24" high
 - Building D - (1 EA) = 48" wide x 24" high
 - Building E - (1 EA) = 48" wide x 16" high

Drawing S002:

Delete Drawing S002 and Replace with Drawing S002 appended to this Addendum.

Drawing R003:

Add the following note immediately after note 14.

15. Install railing on both sides of existing stairs adjacent to opening #117. Modify / replace existing railing at stairs located at opening #118.

Drawing R004:

Table revisions: Revise opening widths to doors #119 and #123 to 60-inches and 68-inches respectively. Revise opening square foot to doors #119 and #123 to 10 square feet and 12 square feet respectively.

QUESTIONS

- Q1. Will Contractor be selected based on lowest lump sum total bid price for all items?
- A1. It is the intent of the OWNER to make award to the lowest responsible qualified bidder. Refer to Section 00200 Article 12.
- Q2. If bids come over budget, will any items be deleted from the scope of work?
- A2. Bidders are advised to bid the project as if all work at all four (4) stations will be awarded.
- Q3. What is the estimated budget for the project?
- A3. Construction cost estimated at approximately \$2 million.
- Q4. It is up to the Bidder to identify/bid CMU wall or not?
- A4. Yes, bidder has the option of which they prefer. Either will work.
- Q5. Is it possible to breakout the different types of flood walls to distinguish between differing applications (e.g. the flood wall at the Boulevard stairs/platform will likely differ from the perimeter walls, which will likely also differ from flood walls at ESWPAF etc.)?
- A5. See revised bid form included in this Addendum No. 2.
- Q6. Is it possible to provide the breakdown of costs as part of a detailed schedule of values after contract award, vs. providing detailed unit costs as part of bid price?
- A6. See revised bid form included in this Addendum No. 2.
- Q7. Is the bid price line item for general conditions limited to no more than 5% of the project cost?
- A7. No.
- Q8. Does City of New Haven waive permit fees for GNHWPCA projects?
- A8. No.
- Q9. If a discrepancy exists between the illustrated drawing location (e.g. interior or exterior of opening) and the table identifying which side barrier is deployed, then does it matter which side it is placed on?
- A9. Yes. In the event of a discrepancy, the information identified in the table shall govern.
- Q10. Drawing R009 - East Street PS – Drawing shows proposed steel plate barriers over two windows; however, the western window has already been eliminated.

- A10. Delete the steel plate barrier for the false window location (western window). Also delete the proposed steel plate barrier over the window in the "Toilet and Shower Room".
- Q11. Is there an available laydown/staging area adjacent to Fort Hale Pumping Station?
- A11. The site has minimal laydown area. The Contractor should plan accordingly.
- Q12. Section 00520 par. 3.2 states substantial completion will be in 300 calendars days after notice to proceed, 00520-2 Par. 3.3 states the Final Completion by Jan. 21, 2021 and in 00410-1, it states "to fully complete all work..." within 365 days. Please confirm substantial completion and final completion durations.
- A12. Substantial Completion shall be as indicated in Section 00520 Par 3.2. Final Completion of all work shall be as stated in par. 3.3. Section 00410 is amended as part of this Addendum #2.
- Q13. Section 01535 states in part 2.02 A.1 that bypass pumping systems shall have enough capacity to pump a peak flow of 600 GPM. Section 01575 states in part 3.01 B that the bypass system shall have a enough capacity to handle full pipe capacity for the pumping station to be bypassed (400 GPM). Please confirm if the bypass pumping system shall handle 400 or 600 GPM.
- A13. Bypass system shall have enough capacity to pump a peak flow of 600 GPM.
- Q14. Per 01270-Measurement and Payment 1.01 H, it states that upon completion of the project and/or remaining unused unit quantities shall not be billed and shall be returned/credited to the Owner. Some of the unit price items pertaining to the flood barriers and concrete walls are not the same in size and construction under the same bid item so the unit price really isn't the same as it's more of an average price. If deleting or adding additional units, this would not accurately represent the real costs.
- A14. See revised Bid Form and Section 01270 included in this Addendum #2.
- Q15. Where do we put items that are not under a unit price item or an allowance? If we put them under general conditions, it will unfairly restrict what we were already putting under the general conditions. If we put it on the unit price item, it will unbalance the unit price items.
- A15. See revised Bid Form and Section 01270 included in this Addendum #2.
- Q16. In Section 01270, there is a restriction of 5% on the general conditions. Our general conditions are significantly over 5% and for this size and type of a job the 5% restriction will be hard to overcome. We would request that this restriction be removed.
- A16. See revised Bid Form and Section 01270 included in this Addendum #2.
- Q17. Drawing R-009 shows the barrier at opening 308 colored red, which is a steel plate barrier. The schedule on R010 indicates that opening 308 is a deployable panel barrier. Drawing

S006 indicates this as a deployable barrier. Please confirm what is to be utilized at this opening.

- A17. Opening #308 shall be a Deployable Panel Barrier as called out on Schedule on R010 and S006.
- Q18. Drawing A201 calls out two W1 vinyl windows and there is no window schedule on the plans or specifications for vinyl windows. Please provide sizes and specifications for W1 windows.
- A18. Windows shall be sized to match existing rough opening of 33" high x 21" wide. See attached Vinyl Window Specification Section 08533.
- Q19. Please confirm where 08520-Aluminum Windows are located.
- A19. There are no proposed aluminum windows. Section 08520 – Aluminum Windows has been provided to describe the requirements for window protection, which is shown on sheet R001 and detailed on sheet RA001.
- Q20. The door schedule on drawing A801 indicates that the doors to be provided at FRP doors/frames. Please provide specification for FRP doors.
- A20. See attached Fiberglass Reinforced Door and Door Frame Systems Specification Section 08163.
- Q21. Please confirm where 08100-Metal doors and frames are located.
- A21. Delete Section 08100-Metal Doors and Frames.
- Q22. Drawings M002 & M004 indicate a sump pump (SP-1) is to be installed in the precast concrete valve vault. Upon review of the specifications and drawings no information could be found on it. Please provide information on this sump pump.
- A22. See attached technical specification Section 11312 – Sump Pump. Provide 18-inch by 18-inch by 4-inches deep recessed sump at location of proposed sump pump.
- Q23. The quantities listed in 00410-Bid Form do not line up with the quantities shown on the contract drawings. For instance, item 20 calls out for 6 and drawings show 5 mats, and item 21 calls out for 6 and drawings show 5 floor drain covers. Please confirm if we are providing the quantities on the drawings or the bid form in our pricing.
- A23. See revised Bid Form and Section 01270 included in this Addendum #2. Provide one (1) additional catch basin mat as spare, over and above the mats shown on the drawings.
- Q24. Please confirm that the work associated with the mechanical/electrical related to the HVAC unit relocation(s) at the East Shore Plant will be paid for under the allowance 2P.

- A24. No. All mechanical and electrical work related to the HVAC unit relocations shall be included in the lump sum price. See revised Bid Form and Section 01270 included in this Addendum #2.
- Q25. Please confirm that any mechanical piping, conduit and wiring, equipment, etc. that needs to be relocated in order to perform proposed work on the ESWPAF Facility, Boulevard Pump Station, and East Street Pump Station will be covered under the allowances provided.
- A25. Confirmed, all mechanical piping, conduit and wiring, equipment, etc. that needs to be relocated in order to perform proposed work on the ESWPAF Facility, Boulevard Pump Station, and East Street Pump Station will be covered under the allowances provided, unless specifically called to be included within the lump sum bid.
- Q26. Section 10700 lists several different manufacturers under each type of barrier with no mention of "or equal" products. Please confirm if "or equals" will be considered for each type of barrier, as it is our preference to have a single source manufacturer for all barriers if possible.
- A26. Section 10700, 2.01B, 2.02B, and 2.03B states "Acceptable Manufacturers: Subject to compliance with requirements specified herein, manufacturers offering products which may be incorporated in the work include the following, or approved equal."
- Q27. Drawing S006 calls for steel plate barriers at the windows. All locations state to see detail 3 on S007. This shows the plates being attached to the slab at EL 10.6 and the top of plate at 16.0. During the site visit, we noticed the bottom of the windows weren't at the same elevation. Is it the intent that all windows [steel plate barriers] are to be attached to the base slab of 10.6? If not, please provide an elevation for each location so the size of the plate can be determined.
- A27. All steel plate barriers shall be attached to the base slab at elevation 10.6.
- Q28. Drawing C005 has a detail for permanent pavement repair and temporary pavement repair. Please confirm where these are applicable.
- A28. These details are applicable where ever the Contractor disturbs existing bituminous concrete pavement.
- Q29. Drawing C003 indicates there is a guy wire coming off an existing utility pole adjacent to new SMH-1 & 2. We believe that this guy wire will need to be temporarily relocated to facilitate installation of the manholes. Please confirm if this pole will require a temporary means of support during installation of the manholes.
- A29. Confirmed. Temporary support will be required. All work required by utility companies shall be paid for under Allowance for Utility Work.
- Q30. Drawing C003 notes that an existing utility pole (pole UI #5479) is to be relocated. Please confirm that any work associated with this relocation will be paid for under bid item 1D.

- A30. Confirmed, all work required by utility companies shall be paid for under Allowance for Utility Work.
- Q31. Drawing C003 notes a new water line being installed to the Fort Hale PS. Will any of this work be performed by the RWA and will this be paid for under bid item 1D. If it is not a complete installation, please define our scope of work.
- A31. RWA will install the corporation stop on the existing main and new water service from main to the curb stop, including the curb stop. RWA work will be paid for under the utility allowance. Contractor shall perform ALL other work, including installation of water meter, and water service from curb stop to building, including excavation backfill, compaction and site restoration. This work will not be measured separately for payment.
- Q32. Plan sheet C003 and M002 – Fort Hale Pump Station: The connection of the existing sanitary sewer to sanitary sewer manhole 1 is indicated at elevation 1.8. The Invert at Sanitary manhole 2 is in at 1.6 and out at 1.5. The existing sanitary manhole adjacent to the wet well is shown to have a bottom elevation of 2.0 and the connection to the wet well is indicated at 1.8. Please clarify the flow of this system.
- A32. The bottom elevation of the existing sanitary sewer noted in the survey should be revised from 2.0 to 1.3±. Disregard invert into existing wet well.
- Q33. Plan sheets C003 and M002 – Fort Hale Pumping Station: The connection of the 6" force main to the existing sanitary manhole via the cross to a plug valve to 45-degree bend is too close to the existing manhole to be physically assembled and connected. The actual lay length of the components will overshoot the existing manhole as configured. Please clarify the layout of this assembly.
- A33. Location and layout of the proposed connection to the existing sanitary manhole shall be confirmed in the field once the exact location of the existing 6" force main is confirmed via required test pit.
- Q34. Drawing C003 details an 8" Bypass Connection which cannot be utilized for temporary bypass discharge due to the line stop being installed in the existing 6" FM. Please confirm if there should be a wet tap with Isolation valve in the 6" FM on the other side of the line stop in order to connect the temporary bypass discharge.
- A34. The line stop is temporary and required to install the bypass connection and cross valving. Once the bypass connection is in place, the line stop shall be removed, pipe restored, and the bypass connection can be used.
- Q35. Please clarify the following questions regarding Drawing RA001, Detail 9 and 12;
- Please provide dimensions for height and width of the insulated panel to be installed.
 - Section 12 does not accurately depict the existing conditions. The existing window frame is set back in the wall with what some kind of flush panel with the existing masonry. Does the existing panel get removed to install the new panel? Can a cut sheet be provided to detail the framing behind the panel?

- c. Can a spec be provided for the insulated panel required to be installed?

A35.

- a. Contractor shall use the following rough opening window dimensions for all proposed Fixed Solid Metal Panels, Access Hatch Replacement, and Windowpane Replacement shown on sheet R001. Contractor shall field verify all dimensions prior to shop drawing submittal, as stated in note 2 of this sheet. Each building has a standard window size.
 - o Building A: (Operations Building) (3 EA) = 40" wide x 28" high
 - o Building B - (7 EA) = 48" wide x 40" high
 - o Building C - (1 EA) = 56" wide x 24" high
 - o Building D - (1 EA) = 48" wide x 24" high
 - o Building E - (1 EA) = 48" wide x 16" high
- b. The existing panel does not have to be removed.
- c. Refer to section 08520.

Q36. Drawing S005; Details 2,5 and 7 – The exterior wall faces call for a concrete liner with the striation to match existing. Is there information available as to what liner was used for the existing foundation.

A36. Contractor to field measure and match existing pattern. Contractor will submit best match pattern to the Owner for approval.

Q37. On Drawing R001 and S002, there is a new concrete wall shown on the north side of the Operations Building that is 12'-7" long. Please clarify the following:

- a. Please provide the length and height of the 6" wall to be demolished.
- b. Drawing S002 references a new wall is to be constructed per detail A, R001 states same wall is per detail 2/2A (detail B). Please confirm which detail will be used here or both. If both apply, please provide interface and details between the two different type of walls.
- c. Please provide existing elevation at the top of the existing stair well wall.
- d. Please provide detail of the new wall(s) interface and tie into existing walls.

A37.

- a. Wall to be demolished is 10' long and 3' high. Additional dimensions provided on revised drawing S002, attached.
- b. Both apply. Refer to revised Drawing S002 for additional clarification. The Interface between the two types of walls shall be poured together, with the horizontal reinforcing continuing between both walls at the interface.
- c. Elevation same as finished floor of existing building.
- d. Interface similar as the one shown for the brick face Detail 4/S-3.

Q38. Drawing RA001; Detail 14 – Please clarify where this detail applies. There aren't any notes for new railing at stairs or ramp, only modification of existing to allow sliding barrier to pass.

A38. See Drawing R003. Install railing on both sides of existing stairs adjacent to opening #117. Modify / replace existing railing at stairs located at opening #118.

Q39 Per Section 13410-1.02D.4, is an I&C qualification statement required 7 days before bid, and if so, who should it be sent to?

A39. The I&C Qualification Statement shall be submitted with the Bid.

Q40 Per Section 13440-2.07A.2, If the spare PLC-CPU is really for the SCADA panel, you're going to have to provide us w/details because the SCADA panel is Owner supplied and we'd have no idea what to supply; but if it applies only to the PCP panel please confirm.

A40. Delete Section 13440-paragraph 2.07A.2.

Q41 On drawing S010 there are multiple details for concrete repairs with no assumed depth of repair. Being that this work is to be priced up under a single unit price item, we would request an assumed maximum depth of concrete repair.

A41. The bidder shall assume an average depth of repair of 3-inches.

Appendices /Enclosures Immediately Follow

1. Pe-Bid Meeting Agenda
2. Pre-Bid Meeting Sign-in Sheet
3. Bid Package dated 12/9/2019
4. Drawing S002
5. Section 01270 Measurement and Payment
6. Section 08163 Fiberglass Reinforced Door and Door Frame Systems
7. Section 08533 Vinyl Window
8. Section 11312 Sump Pumps

END OF ADDENDUM NO. 2

**GREATER NEW HAVEN WATER POLLUTION CONTROL AUTHORITY
NEW HAVEN PUMP STATION RESILIENCY IMPLEMENTATION
PRE-BID MEETING AGENDA
November 20, 2019 @ 11:00 AM**

INTRODUCTIONS AND PROJECT TEAM:

Greater New Haven Water Pollution Control Authority (GNHWPCA) - Owner			
Tom Sgroi Gary Zrelak Joe Megale Charlie Biggs Isabella Schroeder Mario Ricozzi 24-hr Contact	Director of Engineering Director of Operations Deputy Director of Operations Maintenance Administrator Senior Engineer/Project Manager Manager of Design GNHWPCA Control Room "PCC"	(203) 466-5280 x321 (203) 466-5280 x222 (203) 466-5280 x357 (203) 466-5280 x245 (203) 466-5280 x374 (203) 466-5280 x346 (203) 466-5260	tsgroi@gnhwpca.com gzrelak@gnhwpca.com jmegale@gnhwpca.com cbiggs@gnhwpca.com ischroeder@gnhwpca.com mricozzi@gnhwpca.com
Weston and Sampson Engineers (WSE) - Engineer			
Robert Tedeschi Kevin McKenna	Project Manager Project Engineer	(860)-616-6611 (860) 513-1473 x3045	TedeschiR@wseinc.com MckennaK@wseinc.com

- SIGN IN SHEET

PROJECT INFORMATION:

General Bids Due: December 18, 2019 @ 11:00 AM
 Bids to be Held: 90 Days
 Documents: Plans and Specifications
 Anticipated Notice to Proceed: February 2020
 Substantial Completion: 300 Calendar Days
 Liquidated Damages: \$1,000 / day
 Prevailing Wages: Included

PROJECT DESCRIPTION:

Location	Address	Goals	Existing First Floor Elevation*	Design Flood Elevation*
East Shore WPAF	245 East Shore Parkway New Haven CT	Flood proof to help prevent damage to sensitive infrastructure.	14.49	15
East St Pumping Station	1 East Street Ext. New Haven CT	Flood proof to help prevent damage to sensitive infrastructure.	10.63	16

Blvd Pumping Station	19 Sea Street New Haven CT	Flood proof to help prevent damage to sensitive infrastructure.	10.6	15
Fort Hale Pumping Station	25 Woodward Ave New Haven CT	Elevate new pumping station above Design Flood Elevation	10.2	14

**Elevations refer to feet based on NAVD88 Vertical Datum*

Flood Proof Materials:

Includes but not limited to:

- Flood Walls
- Panel Barriers
- Flood Swing Barriers
- Flood Slide Barriers
- Flood Doors
- Flood Proof Windows and Panels
- Floor Drain Covers

Elevation of Fort Hale PS:

Includes but not limited to:

- Addition of second floor
- Relocation of all control panels and electrical to second floor
- Addition of emergency generator
- Rerouting of sewer lines to wet well
- Wet well lining
- Bypass pumping and continued operations during construction
- Neighborhood concerns and architectural details

BID SUBMITTAL REQUIREMENTS:

General Bids:

- Submit on forms included in the documents
- Forms provided
- Bid Bond in the amount of ten percent (10%)
- Bidder's Qualification Statement
- Listing of Proposed Subcontractors
- Non-Collusion Affidavit
- Statement of Bidder's Compliance with Executive Order No. 3
- Statement of Bidder's Compliance with Executive Order No. 17
- Statement of Bidder's Compliance with Executive Order No. 16
- State of Connecticut DAS Contractor Prequalification Update (Bid) Statement (and Prequalification Certificate)

GENERAL:

- December 4, 2019 is last day for questions
- Staging and storage of equipment
- Specific schedule of values requested for Fort Hale PS (See Supplementary Conditions 2.03)
- Project Closeout and As-builts
- Asset and Maintenance Summary Forms
- Bidder's Questions

SITE VISIT:

- Pump Stations open for site visits starting at 1:00pm (see handout schedule)



SSF 2016-02
New Haven Pump Station Resiliency Improvements
Pre-Bid Attendance
Wednesday, November 20, 2019 @ 11:00 AM
Sign-In Sheet

NAME (Please Print)	SIGNATURE	COMPANY	EMAIL
Robert Tedeschi	<i>[Signature]</i>	Weston & Sampson	TEDOSCHIRO@WS&SINC.COM
Kerrin McKenna	<i>[Signature]</i>	Weston & Sampson	McKennaK@WS&SINC.COM
Andrew Chapdelaine	<i>[Signature]</i>	ELM Electric	Achapdelaine@ELMELEC.COM
Isabella Schroeder	<i>[Signature]</i>	GNHWPCA	ischroeder@gnhwPCA.com
Bill Naragon	<i>[Signature]</i>	CH Nickerson	bnaragon@CHNickerson.com
Adam Bisson	<i>[Signature]</i>	C.H. Nickerson	abisson@chnickerson.com
ANDY MANSOOR	<i>[Signature]</i>	RAIN FOR RENT	AMANSOOR@RAINFORRENT.COM
Frank Mastriano	<i>[Signature]</i>	Holzer Construction	estimating@holzerconstruction.com
Kelly Bailey	<i>[Signature]</i>	VORTEX COMPANIES	Kbailey@vortexcompanies.com
Joseph Megale	<i>[Signature]</i>	GNHWPCA	Jmegale@gnhwPCA.com
Mike Huizdos	<i>[Signature]</i>	UNITED RENTALS	mhuizdos1@ur.com
MARIO RICOZZI	<i>[Signature]</i>	GNHWPCA	mrcozzic@gnhwPCA.com
Charliz Biggs	<i>[Signature]</i>	u	cbiggs@gnhwPCA.com

SUBMIT THIS BID PACKAGE



**Greater New Haven Water Pollution Control Authority
Protecting the Environment**

**PROJECT: NEW HAVEN PUMP STATIONS
RESILIENCY IMPROVEMENT PROJECT**

PROJECT NUMBER: SSF 2016-02/FEMA DR4087-CT-74R

**BID OPENING: 11:00 AM
Wednesday
December 18, 2019**



**GREATER NEW HAVEN
WATER POLLUTION CONTROL AUTHORITY
260 EAST STREET
NEW HAVEN, CT 06511
PHONE: 203.466.5280 FAX:203.772.2027
WEB: WWW.GNHWPCA.COM
EMAIL: ENGINEERING@GNHWPCA.COM**

EMERGENCY NUMBER: 203-466-5260

TABLE OF CONTENTS

<u>Division</u>	<u>Section Number</u>
0 BIDDING AND CONTRACT REQUIREMENTS	
Form of General Bid: Pages 00410-1 to 00410-6	00410
Bidder's Qualification Statement	00420
Listing of Proposed Subcontractors	00420
Non-Collusion Affidavit	00420
Bid Bond	00420
Statement of Bidder's Compliance with Executive Order No. 3	00420
Statement of Bidder's Compliance with Executive Order No. 16	00420
Statement of Bidder's Compliance with Executive Order No. 17	00420
State of CT DAS Contractor Prequalification Update (Bid) Statement (and Prequalification Certificate)	00420

END OF SECTION

SECTION 00410

FORM OF GENERAL BID

Proposal of _____ (hereinafter called "Bidder")*

☐ a corporation, organized and existing under the laws of the State of Connecticut

☐ a partnership

☐ a joint venture

☐ a limited liability company

☐ an individual doing business as _____

*Insert corporation, partnership, joint venture or individual as applicable.

To the Greater New Haven Water Pollution Control Authority (hereinafter called "Owner").

Gentlemen:

The Bidder, in compliance with your invitation for bids for the New Haven Pump Station Resiliency Improvements Project, having examined the plans and specifications with related documents and the site of the proposed work and being familiar with all of the conditions surrounding the construction of the proposed project including the availability of materials and labor, hereby proposes to furnish all superintendence, labor, services, materials, equipment, plant, machinery, apparatus, appliances, tools, supplies, bailing, shoring, removal, and all other things necessary to construct the project in accordance with the Contract Documents, as prepared by Weston & Sampson Engineers, Inc., within the time set forth therein and at the prices stated below. These prices are to cover all expenses incurred in performing the work required under the Contract Documents, of which this proposal is a part.

The Bidder hereby agrees to commence work under this Contract on or before a date to be fixed in the written "Notice to Proceed" given by the Owner to the Contractor and to fully complete all work related to the Contract as stated in Section 00520. The Bidder further agrees to pay as liquidated damages in accordance with Section 00520.

Bidder acknowledges receipt of the following addenda:

No.	Dated:
No.	Dated:
No.	Dated:
No.	Dated:

The Bidder agrees to perform the work described in the specifications and shown on the plans for the following lump sum prices:

All entries shall be made clearly in ink or typewritten. Amounts are to be shown in both words and figures. Discrepancies between words and figures will be resolved in favor of words. Discrepancies between the indicated total of lump sum prices multiplied by the estimated quantities and the correct total will be resolved in favor of the correct total. Discrepancies between the indicated sum of any column of figures and the correct sum thereof will be resolved in favor of the correct sum.

Bid price for Items 1A through 4H, inclusive:

_____ Dollars	
(Words)	
And _____ cents	\$ _____
(Words)	(Numbers)

The submission of the proposed price is as detailed in the following pages (excluding sales and use tax)

Company Name: _____

12/18/2019

BASE PRICE

Item No.	DESCRIPTION	UNIT PRICE (dollars in words)	UNIT PRICE (\$s)	Quantity	Unit	AMOUNT
FORT HALE PUMP STATION						
1A	Fort Hale PS Improvements		\$	1	LS	\$
1B	Test Pits		\$	50	CY	\$
1C	Allowance for Utility Company Work	twenty-five thousand	\$ 25,000.00	1	Allow	\$ 25,000.00
1D	Repair of Deteriorated or Spalled Concrete		\$	200	SF	\$
1E	Allowance for Abatement of Contaminated Materials	ten thousand	\$ 10,000.00	1	Allow	\$ 10,000.00
1F	Fort Hale PS General Conditions		\$	1	LS	\$
EAST SHORE WPAF (ESWPAF)						
2A	ESWPAF-Operations Building Improvements		\$	1	LS	\$
2B	Allowance for Removal/Relocation of Existing Conduit and Equipment	twenty-five thousand	\$ 25,000.00	1	Allow	\$ 25,000.00
2C	ESWPAF General Conditions		\$	1	LS	\$
BOULEVARD PUMP STATION						
3A	Boulevard PS Improvements		\$	1	LS	\$
3B	Allowance for Removal/Relocation of Existing Conduit and Equipment	twenty-five thousand	\$ 25,000.00	1	Allow	\$ 25,000.00
3C	Boulevard PS General Conditions		\$	1	LS	\$
EAST STREET PUMP STATION						
4A	East Street PS Improvements		\$	1	LS	\$
4B	Allowance for Removal/Relocation of Existing Conduit and Equipment	twenty-five thousand	\$ 25,000.00	1	Allow	\$ 25,000.00
4C	East Street PS General Conditions		\$	1	LS	\$
TOTAL						\$

The above bid prices shall include all labor, materials, bailing, shoring, removal, overhead, profit, insurance, etc., to cover the finished work of the several kinds called for.

The Contract will be awarded to the lowest eligible and responsible bidder on the basis of the lowest bid for the base bid for the Project.

The Bidder understands that the Owner reserves the right to reject any or all bids and to waive any informalities in the bidding.

The Bidder agrees that this bid shall be good and may not be withdrawn for a period of ninety (90) days, Saturdays, Sundays and legal holidays excluded, after the opening of bids.

Within ten (10) days of receipt of the written notice of acceptance of this bid, the Bidder will execute the formal agreement attached in Section 00520, Agreement.

Bid security is attached in the sum of ten percent (10%) of the total base bid in accordance with the conditions of Section 00200, Instructions to Bidders. The bid security may become the property of the Owner in the event the Contract and bond are not executed within the time set forth above.

The selected Contractor shall furnish a performance bond and a payment bond in an amount at least equal to one hundred percent (100%) of the contract prices in accordance with Section 00610, Performance Bond, Section 00615, Payment Bond, and as stipulated in paragraph 5.01 of Section 00700, Standard General Conditions of the Construction Contract of these specifications.

The undersigned hereby certifies that it is able to furnish labor that can work in harmony with all other elements of labor employed or to be employed in the work.

The undersigned certifies under penalties of perjury that this bid is in all respects bona fide, fair and made without collusion or fraud with any other person. As used in this paragraph the word "person" shall mean any natural person, joint venture, partnership, corporation or other business or legal entity which sells materials, equipment or supplies used in or for, or engages in the performance of, the same or similar construction, reconstruction, installation, demolition, maintenance or repair work or any part thereof.

The undersigned further certifies under penalty of perjury that the said undersigned is not presently debarred from doing public construction work in the State of Connecticut under applicable debarment provisions of the Connecticut General Statutes or any rule or regulations promulgated thereunder.

Respectfully submitted:

Date _____

By _____
(Signature)

(Name – Typed or Printed)

(Title)

(SEAL - if bid is by a corporation)

(Business Name)

(Federal ID Number)

(Business Address)

(City and State)

(Telephone Number)

(Fax Number)

SECTION 00420

BID FORM ATTACHMENTS

- Bidder's Qualification Statement
- Listing of Proposed Subcontractors
- Non-Collusion Affidavit
- Bid Bond
- Statement of Bidder's Compliance with Executive Order No. 3
- Statement of Bidder's Compliance with Executive Order No. 17
- Statement of Bidder's Compliance with Executive Order No. 16
- State of Connecticut DAS Contractor Prequalification Update (Bid) Statement (and Prequalification Certificate)

BIDDER'S QUALIFICATION STATEMENT

TO: Greater New Haven Water Pollution Control Authority
hereinafter called "Owner"

Pursuant to bidding requirements for the Work titled: New Haven Pump Station Resiliency Improvements Project

The Bidder is qualified to complete the Work as stated below:

ORGANIZATION

If your organization is a corporation, provide the following:

Date of incorporation: _____

State of incorporation: _____

President's name: _____

Vice-president's name(s): _____

Secretary's name: _____

Treasurer's name: _____

If your organization is a partnership, answer the following:

Date of organization: _____

Type of partnership: _____

Name(s) of general partner(s): _____

If your organization is individually owned, answer the following:

Date of organization: _____

Name of owner: _____

If the form of your organization is other than those listed above, describe it and name the principles:

EXPERIENCE

List the categories of work that your organization normally performs with its own forces.

Claims and Suits. (If the answer to any of the questions below is yes, please attach details.)

- No ☐ Yes ☐ Has your organization ever failed to complete any work awarded to it?
- No ☐ Yes ☐ Are there any judgements, claims, arbitration proceedings or suits pending or outstanding against your organization or its officers?
- No ☐ Yes ☐ Has your organization filed any lawsuits or requested arbitration with regard to construction contracts within the last five years?
- No ☐ Yes ☐ Within the last five years, has any officer or principal of your organization ever been an officer or principal of another organization when it failed to complete a construction contract?

On a separate sheet, list major construction projects your organization has in progress, giving the name of project, owner, engineer, contract amount, percent complete and scheduled completion date. State the total worth of work in progress and under construction.

On a separate sheet, list the major projects your organization has completed in the past five years, giving the name of the project, owner, engineer, contact information, contract amount, date of completion and percentage of the cost of the work performed with your own forces. State average annual amount of construction work performed during the past five years.

On a separate sheet, list the construction experience and present commitments of the key individuals of your organization.

Signature _____ Date _____

Printed Name _____

Title _____

LISTING OF PROPOSED SUBCONTRACTORS

Bidder intends to utilize the following subcontractors on this project:

If none, write "none" here: _____

	<i>Name, Address and Federal ID Number of Subcontractor</i>	<i>Description of Work</i>		<i>Est. Value of Work</i>
1.			\$	
2.			\$	
3.			\$	
4.			\$	
5.			\$	
6.			\$	

Submit Instrumentation & Controls Subconsultant Qualification Statement Per Section 13410-1.02D.4

NON-COLLUSION AFFIDAVIT

GREATER NEW HAVEN WATER POLLUTION CONTROL AUTHORITY:

This is to certify that in submitting this bid, BIDDER represents that this Bid is not made in the interest of or on behalf of any undisclosed person and is not submitted in conformity with any agreement or rules of any group, association, organization, or corporation; BIDDER has not directly or indirectly induced or solicited any other Bidder to submit a false or sham Bid; BIDDER has not solicited or induced any person, firm, or corporation to refrain from bidding; and BIDDER has not sought by collusion to obtain for himself any advantage over any other Bidder or over OWNER; and the BIDDER or any person in his behalf, has not agreed, connived, or colluded to produce a deceptive show of competition in the matter of the bidding or award of the referenced contract.

Signature to be by signer of Form of General Bid.

Signature

Printed Name

Title

Subscribed and sworn to before me this ____ day of _____, 201__.

Notary Public

My commission expires on: _____

BID BOND

BIDDER (Name and Address):

SURETY (Name and Address of Principal Place of Business):

OWNER (Name and Address):

BID

BID DUE DATE: _____

PROJECT (Brief Description Including Location):

BOND

BOND NUMBER: _____

DATE (Not later than Bid due date): _____

PENAL SUM: _____

(Words)

(Figures)

IN WITNESS WHEREOF, Surety and Bidder, intending to be legally bound hereby, subject to the terms printed on the reverse side hereof, do each cause this Bid Bond to be duly executed on its behalf by its authorized officer, agent, or representative.

BIDDER

SURETY

_____(Seal)

_____(Seal)

Bidder's Name and Corporate Seal

Surety's Name and Corporate Seal

By: _____

Signature and Title

By: _____

Signature and Title
(Attach Power of Attorney)

Attest: _____

Signature and Title

Attest: _____

Signature and Title

Note: (1) Above addresses are to be used for giving required notice.
(2) Any singular reference to Bidder, Surety, OWNER or other party shall be considered plural where applicable.

1. Bidder and Surety, jointly and severally, bind themselves, their heirs, executors, administrators, successors and assigns to pay to OWNER upon default of Bidder the penal sum set forth on the face of this Bond.

2. Default of Bidder shall occur upon the failure of Bidder to deliver within the time required by the Bidding Documents (or any extension thereof agreed to in writing by OWNER) the executed Agreement required by the Bidding Documents and any performance and payment Bonds required by the Bidding Documents.

3. This obligation shall be null and void if:

3.1. OWNER accepts Bidder's Bid and Bidder delivers within the time required by the Bidding Documents (or any extension thereof agreed to in writing by OWNER) the executed Agreement required by the Bidding Documents and any performance and payment Bonds required by the Bidding Documents, or

3.2. All Bids are rejected by OWNER, or

3.3. OWNER fails to issue a Notice of Award to Bidder within the time specified in the Bidding Documents (or any extension thereof agreed to in writing by Bidder and, if applicable, consented to by Surety when required by paragraph 5 hereof).

4. Payment under this Bond will be due and payable upon default by Bidder and within 30 calendar days after receipt by Bidder and Surety of written notice of default from OWNER, which notice will be given with reasonable promptness, identifying this Bond and the Project and including a statement of the amount due.

5. Surety waives notice of and any and all defenses based on or arising out of any time extension to issue Notice of Award agreed to in writing by OWNER and Bidder, provided that the total time for issuing Notice of Award including extensions shall not in the aggregate exceed 120 days from Bid due date without Surety's written consent.

6. No suit or action shall be commenced under this Bond prior to 30 calendar days after the notice of default required in paragraph 4 above is received by Bidder and Surety and in no case later than one year after Bid due date.

7. Any suit or action under this Bond shall be commenced only in a court of competent jurisdiction located in the state in which the Project is located.

8. Notices required hereunder shall be in writing and sent to Bidder and Surety at their respective addresses shown on the face of this Bond. Such notices may be sent by personal delivery, commercial courier or by United States Registered or Certified Mail, return receipt requested, postage pre-paid, and shall be deemed to be effective upon receipt by the party concerned.

9. Surety shall cause to be attached to this Bond a current and effective Power or Attorney evidencing the authority of the officer, agent or representative who executed this Bond on behalf of Surety to execute, seal and deliver such Bond and bind the Surety thereby.

10. This Bond is intended to conform to all applicable statutory requirements. Any applicable requirement of any applicable statute that has been omitted from this Bond shall be deemed to be included herein as if set forth at length. If any provision of this Bond conflicts with any applicable statute, then the provision of said statute shall govern and the remainder of this Bond that is not in conflict therewith shall continue in full force and effect.

11. The term "Bid" as used herein includes a Bid, offer or proposal as applicable.

STATEMENT OF BIDDERS COMPLIANCE WITH EXECUTIVE ORDER NO. 3

This statement must be completed by the Bidder and shall accompany his bid for this project.

IT IS HEREBY CERTIFIED THAT:

NAME OF BIDDER _____

BUSINESS ADDRESS _____

PLEASE CHECK THE APPROPRIATE LINE

Has _____ has not _____ previously performed work under the conditions of the Governor's Executive Order No. 3 of the State of Connecticut, or any preceding similar Executive Order with regards to Non-Discrimination.

Signature

Title

Date

IMPORTANT: THIS STATEMENT MUST BE SUBMITTED WITH BID

Connecticut general statutes require nondiscrimination clauses in state contracts and subcontracts for construction on public buildings, other public works and goods and services. Henceforth all state contracts and subcontracts for construction on public buildings, other public works and goods and services shall contain a provision rendering such contract or subcontract subject to this Order, and that such contract or subcontract may be canceled, terminated or suspended by the labor commissioner for violation of or noncompliance with this Order or state or federal laws concerning nondiscrimination. Each contractor having a contract containing the provisions prescribed in section 4-114a of the 1969 supplement to the general statutes, shall file, and shall cause each of his subcontractors to file, compliance reports with the contracting agency or the labor commissioner.

STATEMENT OF BIDDERS COMPLIANCE WITH EXECUTIVE ORDER NO. 17

This statement must be completed by the Bidder and shall accompany his bid for this project.

IT IS HEREBY CERTIFIED THAT:

NAME OF BIDDER _____

BUSINESS ADDRESS _____

PLEASE CHECK THE APPROPRIATE LINE

Has _____ has not _____ previously performed work under the conditions of the Governor's Executive Order No. 17 of the State of Connecticut, or any preceding similar Executive Order with regards to Non-Discrimination.

Signature

Title

Date

IMPORTANT: THIS STATEMENT MUST BE SUBMITTED WITH BID

Connecticut general statutes require nondiscrimination clauses in state contracts and subcontracts for construction on public buildings, other public works and goods and services. Henceforth all state contracts and subcontracts for construction on public buildings, other public works and goods and services shall contain a provision rendering such contract or subcontract subject to this Order, and that such contract or subcontract may be canceled, terminated or suspended by the labor commissioner for violation of or noncompliance with this Order or state or federal laws concerning nondiscrimination. Each contractor having a contract containing the provisions prescribed in section 4-114a of the 1969 supplement to the general statutes, shall file, and shall cause each of his subcontractors to file, compliance reports with the contracting agency or the labor commissioner.

STATEMENT OF BIDDERS COMPLIANCE WITH EXECUTIVE ORDER NO. 16

This statement must be completed by the Bidder and shall accompany his bid for this project.

IT IS HEREBY CERTIFIED THAT:

NAME OF BIDDER _____

BUSINESS ADDRESS _____

Complies with the State of Connecticut Violence in the Workplace Prevention Policy as outlined in Executive Order No. 16.

Signature

Title

Date

State of Connecticut
Department of Administrative Services (DAS) Contractor Prequalification
Update (Bid) Statement
(Statement to be included with the bid)

Connecticut General Statute §4a-100 and Connecticut General Statute §4b-91

Each bid submitted for a contract shall include a copy of a prequalification certificate issued by the Commissioner of Administrative Services. The bid shall also be accompanied by an **update bid statement** in such form as the Commissioner of Administrative Services prescribes. The form for such **update bid statement** shall provide space for information regarding all projects completed by the bidder since the date the bidder's prequalification certificate was issued or renewed, all projects the bidder currently has under contract, including the percentage of work on such projects not completed, the names and qualifications of the personnel who will have supervisory responsibility for the performance of the contract, any significant changes in the bidder's financial position or corporate structure since the date the certificate was issued or renewed, any change in the contractor's qualification status, and such other relevant information as the Commissioner of Administrative Services prescribes. Any bid submitted without a copy of the prequalification certificate and an **update bid statement** shall be invalid. Any public agency that accepts a bid submitted without a copy of such prequalification certificate and an **update bid statement**, as required by this section, may become ineligible for the receipt of funds related to such bid.

Name of Project that company is bidding on:		
Project Number:		
Name of Company:		
FEIN:		
Company Address:		
Prequalification Contact:		Telephone Number:
Date of Prequalification with the DAS:	Single Limit:	Aggregate Work Capacity (AWC):
* This amount equals your company's AWC minus the Total \$ Amount of Work Remaining.		* Remaining Aggregate Work Capacity:

Please list all of your company's BONDED PROJECTS (BOTH PUBLIC AND PRIVATE) WHICH WERE 100% COMPLETED SINCE THE DATE YOUR PREQUALIFICATION WAS ISSUED OR RENEWED: (Please add additional page(s) if required)

Name of Project	Owner of Project	Date Project Completed	Total Contract Amount

Please list all of your company's BONDED PROJECTS (BOTH PUBLIC AND PRIVATE) CURRENTLY UNDER CONTRACT:
(Please add additional page(s) if required. Please total the Work Remaining column)

Name of Project	Owner of Project	Total Contract Amount	% Complete	Work Remaining (\$)
Total \$ Amount of Work Remaining →				

Please list the names and titles of the personnel who will have supervisory responsibility for the performance of the contract being bid on:
(Please add additional page(s) if required)

Individual Name	Title of Individual

Have there been any changes in your company's financial condition or business organization, which might affect your company's ability to successfully complete this contract?

Yes ☐ No ☐

If yes, please explain:

I certify under penalty of law that all of the information contained in this Update (Bid) Statement is true and accurate to the best of my knowledge as of the date below.

Signature

Date

It is the responsibility of the Awarding Authority to determine if any of the information provided above will impact the contractor's performance on this project.
The DAS' Contractor Prequalification Program can be reached at (860) 713-5280

P:\CT\GNHWPCA\2190262 New Haven HMGP\GNHWPCA-HMGP-CAD\Structural\Current\JR.dwg

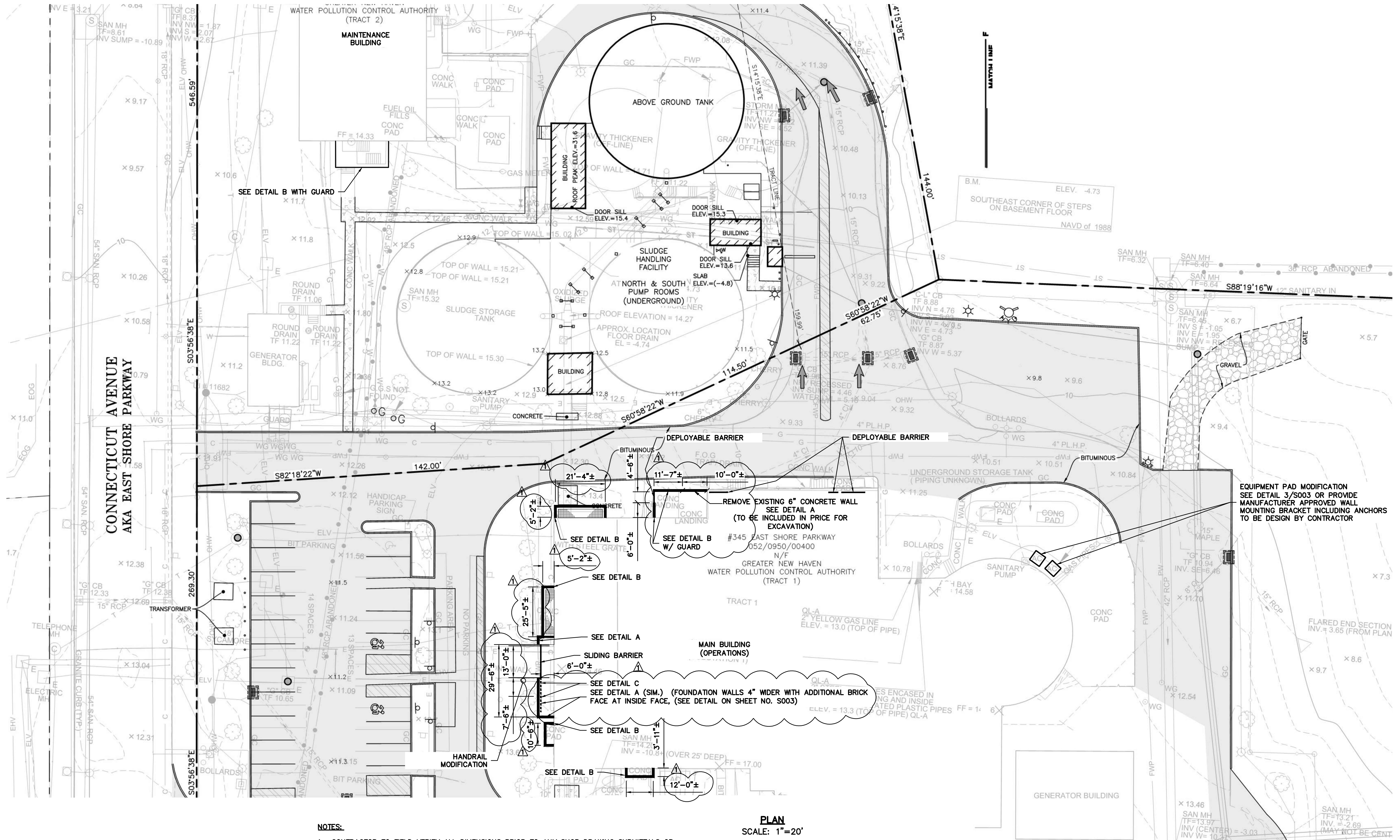

NOTES:

1. CONTRACTOR TO FIELD VERIFY ALL DIMENSIONS PRIOR TO ANY SHOP DRAWING SUBMITTALS OR FABRICATION OF ELEMENTS.
2. FOR DEPLOYABLE BARRIERS, SEE SPECIFICATIONS.
3. FOR DETAIL "A" SEE DRAWING S003.
4. FOR DETAIL "B" SEE DRAWING S003.
5. FOR DETAIL "C" SEE DRAWING S003.

PLAN
SCALE: 1"=20'

REFERENCE NOTES:

1. FOR DETAIL A OPTIONS SEE 1/S003 OR 1A/S003.
2. FOR DETAIL B OPTION SEE 2/S003 OR 2A/S003.
3. FOR DETAIL C SEE 5/2003.

Rev. NO.	Date	Drwn.	Chkd.	Remarks
12.6.19	MM	PJG		MODIFIED DIMENSIONS AND DETAIL CALLOUTS

Date: AUGUST, 2019
Drawn by:
Reviewed by:
Approved by:

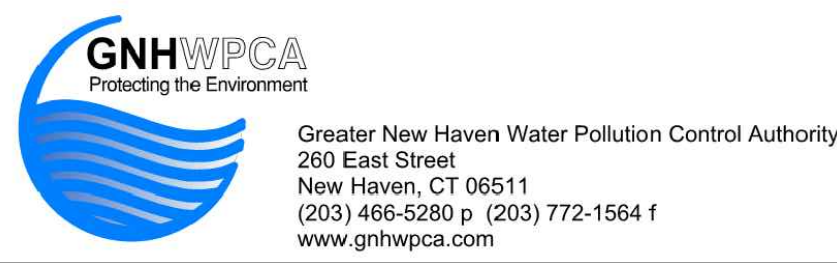

Seal:



Project: New Haven Pumping Stations Resiliency Improvement Project
Project No: SSF 2016-02
W&S Project No: 2190262
Issued For: BIDDING

Drawing Title: ESWPAF - OPERATIONS BUILDING BARRIER LOCATION PLAN

Sheet Number: S002

SECTION 01270

MEASUREMENT AND PAYMENT

PART 1 - DESCRIPTION

1.01 GENERAL:

- A. The following subsections describe the measurement of and payment for the work to be done under the items listed in Section 00410, FORM OF GENERAL BID.
- B. All work performed as described in these contract documents will be paid for under one or more of the items listed in the FORM OF GENERAL BID. All other activities required in connection with performance of the work, including all work required under Division 1, GENERAL REQUIREMENTS, whether described in the contract documents or mandated by applicable codes, permits and laws, will not be separately paid for unless specifically provided for in the form of general bid, but will be considered incidental to performance of the overall project.
- C. Each unit or lump-sum price stated in the FORM OF GENERAL BID shall constitute full compensation as herein specified for each item of work completed in accordance with the drawings and specifications, including cleanup.
- D. The payment items listed herein and in the FORM OF GENERAL BID are intended to provide full payment for the work shown on the drawings and specified herein. Any work called for or implied in the documents but not listed as a payment item shall be considered incidental to the overall project.
- E. Unless otherwise noted, each item shall be furnished and installed in accordance with the technical section whether a specific applicable payment item exists or not.
- F. Unless otherwise noted, all earthwork shall be included under any item requiring excavation. The prices for those items that involve excavation shall include compensation for disposal of surplus excavated material, and installation of all necessary sheeting and bracing.
- G. In all items involving excavation, the price shall be based on doing the entire excavation in earth. Where rock is excavated, the price therefor shall be in addition to the cost of excavating earth and no deduction shall be made in the amount for earth excavation.
- H. If changes are made to the design that was shown on the Drawings and Specifications in the original contract and should such changes increase or decrease the quantity of work to be performed, an adjustment will be made therefore based on the Unit Quantities' described herein. No work shall be performed in excess of the Unit Quantities provided in the FORM OF GENERAL BID without written approval. Upon completion of the project remaining and/or unused Unit Quantities shall not be billed and shall be returned/credited to the Owner.

1.02 ITEM 1: FORT HALE WASTEWATER PUMPING STATION:

A. FORT HALE PS IMPROVEMENTS (ITEM 1A)

1. The lump sum price shall constitute full compensation for furnishing all labor, materials, tools, and all equipment required, as well as coordination between disciplines, to construct the Fort Hale Wastewater Pumping Station Upgrade and related facilities in their entirety as shown on the Drawings and called for in the Contract Documents, complete, in place and accepted by the Owner.
2. Prior to construction, the Contractor shall review the Contract Documents and coordinate all equipment between the different construction disciplines for location, size, serviceability, support systems, connections (piping, electrical, instrumentation, HVAC, plumbing), incidentals and any and all other components required for a complete and functional system. If one system is shown on one set of discipline drawings / specifications but the same system is missing or incomplete on another set of discipline drawings/specifications the Contractor, at no additional cost to the Owner, shall provide all necessary equipment, materials, labor, support systems, connections (piping, electrical, instrumentation, HVAC, plumbing), coordination, incidentals and any and all other components required for furnishing and installing the system complete as well as providing a complete and functional system.
3. The Contract Documents are provided to allow each of the Contractors to scope and bid the project. The actual construction / installation requirements can vary from vendor to vendor and are provided after submittal and incorporation of equipment shop/coordination drawings by the Contractors. The installation and integration requirements for all process equipment, components and controls are subject to modifications based on the actual equipment submittals of the equipment to be furnished. Coordination is required between all equipment vendors as well as between the Contractor and the Sub-Contractors. Coordination between all equipment vendors and Contractors shall be required and provided at no additional cost to the Owner on an as-needed / required basis such that a complete and functional system is provided.
4. Payment for Fort Hale Pumping Station Improvements shall include by-pass pumping, including all related operational and maintenance costs, for the duration necessary to complete the work, metal and concrete support structures, control building, metal platform and stairs, pumps, piping, valves, wet well coating, electrical, instrumentation and HVAC equipment, precast valve vault, concrete, furnishing, installing and testing pump station equipment, including electrical and alarm (telemetry) equipment; commissioning, paving, loaming and seeding, landscaping, fencing and all other items required to provide a completed pumping station as shown on the drawing and specified herein.
5. Payment for the work under this item shall also include full compensation for all labor, equipment, materials and incidentals as required for the construction of all site work and structural work as shown on the contract drawings, including but not limited

to, clearing and grubbing, removal of top soil, test pits; erosion and sedimentation control installation, monitoring, maintaining, inspections, and removal; utility relocation and installation, all earth excavation, backfill, compaction and compaction testing, removal, transportation and disposal of all excavated materials; connection to existing structures, connections to existing utilities, site improvements, site restoration including but not limited to, bituminous concrete pavement, concrete sidewalks, fencing and gates, porous flexible paving, stone surfaces, project close out documents including but not limited to record drawings, operation and maintenance manuals, start-up services, training, and all related and incidental work as shown in the Contact Documents, complete and accepted by the Owner.

6. Payment for the work under this item shall also include full compensation for all labor, equipment, materials and incidentals as required for abatement, handling, removal, transportation, documentation, sampling, and proper disposal of any contaminated materials (PCB, lead, and Asbestos) encountered by the Contractor during construction activities.

B. TEST PITS (ITEM 1B):

1. Test pits as ordered by the Engineer and not incidental to construction shall be measured per cubic yard excavated and backfilled under the Item "Test Pits."
2. Test pits shall be paid at the contract unit price under the item "Test Pits." The unit price under this item shall constitute full compensation for all excavation, backfill, pavement repair, surface restoration, or other work incidental to excavation or restoration of test pits.

C. ALLOWANCE FOR UTILITY COMPANY WORK (ITEM 1C):

1. The allowance under this item shall be utilized as payment for charges incurred by the various utility companies impacted by the proposed project. Work under this allowance item shall be negotiated between the Contractor and the Owner based on the actual field conditions and the modifications required. Work under this item shall include adjustments for and direct labor costs only with a maximum profit of 5%. Indirect costs and overhead shall not be paid for separately and shall be considered included in the lump sum fees under Bid Item #1A.
2. Additional items, which are acceptable for payment under this item, consist of Utility Service Entrance fees and any modifications to the Utility Service Entrance received in writing from the Utility Service Company on Utility Service Company letterhead and signed by an authorized representative of the Utility Service Company.
3. Payment under this allowance shall constitute full compensation for furnishing all labor, materials, tools and equipment, incidentals and constructing the modifications, complete as negotiated between the Contractor and Owner.

D. REPAIR OF DETERIORATED OR SPALLED CONCRETE (ITEM 1D):

1. Repair of deteriorated or spalled concrete, as required by the Engineer, shall be measured in place per square foot of surface area repaired. Quantities shall be rounded up to the nearest whole number value.
2. Payment for repair of deteriorated or spalled concrete, as required by the Engineer, shall include full compensation for all labor, equipment, materials and incidentals as required for the repair of deteriorated or spalled concrete as specified in the Contract Documents meeting the approval of the Engineer. Work under this item also providing and placing materials for structural repairs including setup and breakdown of any and all scaffolding and support systems and incidentals as required.

E ALLOWANCE FOR ABATEMENT OF CONTAMINATED MATERIAL (ITEM 1E):

1. The allowance under this item shall be utilized as payment for the abatement, handling, removal, transportation, documentation, sampling, and proper disposal of any contaminated materials encountered by the Contractor during construction activities. Only contaminated materials that are removed from the site and disposed of at a licensed disposal site shall be measured for payment. Work under this allowance item shall be negotiated between the Contractor and the Owner based on the actual field conditions and the materials encountered. Work under this item shall include adjustments for and direct labor costs only with a maximum profit of 5%. Indirect costs and overhead shall not be paid for separately and shall be considered included in the lump sum fees under Bid Item #1A.
2. Payment will also be made based on invoices submitted by testing and disposal facilities. No Mark-up will be allowed. The Contractor shall review said invoices for accuracy and forward copies of same to the Engineer and include the cost in his Application for Payment. Actual payment shall be made by the Contractor and the Contractor shall be reimbursed by the Owner through the monthly applications for payment.

1.03 ITEM 2: ESWPAF – OPERATIONS BUILDING:

A. ESWPAF – OPERATIONS BUILDING IMPROVEMENTS (ITEM 2A)

1. The lump sum price shall constitute full compensation for furnishing all labor, materials, tools, and all equipment required, as well as coordination between disciplines, to provide all resiliency improvements and related facilities in their entirety as shown on the Drawings and called for in the Contract Documents, complete, in place and accepted by the Owner.
2. Prior to construction, the Contractor shall review the Contract Documents and coordinate all equipment between the different construction disciplines and manufacturer requirements for location, size, serviceability, support systems,

connections, incidentals and any and all other components required for a complete and functional system.

3. The Contract Documents are provided to allow each of the Contractors to scope and bid the project. The actual construction / installation requirements can vary from vendor to vendor and are provided after submittal and incorporation of equipment shop/coordination drawings by the Contractors. The installation and integration requirements for all resiliency improvements are subject to modifications based on the actual equipment submittals of the equipment to be furnished. Coordination is required between all equipment vendors as well as between the Contractor and the Sub-Contractors. Coordination between all equipment vendors and Contractors shall be required and provided at no additional cost to the Owner on an as-needed / required basis such that a complete and functional system is provided.
4. Payment for ESWPAF-Operations Building Improvements shall include but not limited to all deployable and permanent flood barriers, flood door, fixed solid metal panels, access hatch replacement, window pane replacement, floor drain covers, trench drain and catch basin covers, concrete/masonry flood walls extensions and free standing, removal of existing 6" thick concrete wall, raise existing HVAC units including associated ductwork and electrical, installation of new railings and modification of existing railings all other items required to provide all resiliency improvements as shown on the drawing and specified herein.
5. Payment for the work under this item shall also include full compensation for all labor, equipment, materials and incidentals as required for the construction work as shown on the contract drawings, including but not limited to, all design work, submittals, labor and materials, and all other incidental items project close out documents including but not limited to record drawings, operation and maintenance manuals, training, and all related and incidental work as shown in the Contract Documents, complete and accepted by the Owner.

1.04 BOULEVARD PUMPING STATION (ITEM 3):

A. BOULEVARD PUMPING STATION IMPROVEMENTS (ITEM 3A)

1. The lump sum price shall constitute full compensation for furnishing all labor, materials, tools, and all equipment required, as well as coordination between disciplines, to provide all resiliency improvements and related facilities in their entirety as shown on the Drawings and called for in the Contract Documents, complete, in place and accepted by the Owner.
2. Prior to construction, the Contractor shall review the Contract Documents and coordinate all equipment between the different construction disciplines and manufacturer requirements for location, size, serviceability, support systems, connections, incidentals and any and all other components required for a complete and functional system.

3. The Contract Documents are provided to allow each of the Contractors to scope and bid the project. The actual construction / installation requirements can vary from vendor to vendor and are provided after submittal and incorporation of equipment shop/coordination drawings by the Contractors. The installation and integration requirements for all resiliency improvements are subject to modifications based on the actual equipment submittals of the equipment to be furnished. Coordination is required between all equipment vendors as well as between the Contractor and the Sub-Contractors. Coordination between all equipment vendors and Contractors shall be required and provided at no additional cost to the Owner on an as-needed / required basis such that a complete and functional system is provided.
4. Payment for Boulevard Pumping Station Improvements shall include but not limited to all deployable flood barriers, steel plate barriers, floor drain covers, concrete flood walls interior and exterior, wall drains, infill of existing loading dock leveler, removal and installation of railings, supports, hardware, plugs and all other items required to provide all resiliency improvements as shown on the drawing and specified herein.
5. Payment for the work under this item shall also include full compensation for all labor, equipment, materials and incidentals as required for the construction work as shown on the contract drawings, including but not limited to, all design work, submittals, labor and materials, and all other incidental items project close out documents including but not limited to record drawings, operation and maintenance manuals, training, and all related and incidental work as shown in the Contact Documents, complete and accepted by the Owner.

1.05 EAST STREET PUMPING STATION (ITEM 4):

A. EAST STREET PUMPING STATION IMPROVEMENTS (ITEM 4A)

1. The lump sum price shall constitute full compensation for furnishing all labor, materials, tools, and all equipment required, as well as coordination between disciplines, to provide all resiliency improvements and related facilities in their entirety as shown on the Drawings and called for in the Contract Documents, complete, in place and accepted by the Owner.
2. Prior to construction, the Contractor shall review the Contract Documents and coordinate all equipment between the different construction disciplines and manufacturer requirements for location, size, serviceability, support systems, connections, incidentals and any and all other components required for a complete and functional system.
3. The Contract Documents are provided to allow each of the Contractors to scope and bid the project. The actual construction / installation requirements can vary from vendor to vendor and are provided after submittal and incorporation of equipment shop/coordination drawings by the Contractors. The installation and integration requirements for all resiliency improvements are subject to modifications based on the actual equipment submittals of the equipment to be furnished. Coordination is required

between all equipment vendors as well as between the Contractor and the Sub-Contractors. Coordination between all equipment vendors and Contractors shall be required and provided at no additional cost to the Owner on an as-needed / required basis such that a complete and functional system is provided.

4. Payment for East Street Pumping Station Improvements shall include but not limited to all deployable flood barriers, steel plate barriers, floor drain covers, supports, hardware, and all other items required to provide all resiliency improvements as shown on the drawing and specified herein.
5. Payment for the work under this item shall also include full compensation for all labor, equipment, materials and incidentals as required for the construction work as shown on the contract drawings, including but not limited to, all design work, submittals, labor and materials, and all other incidental items project close out documents including but not limited to record drawings, operation and maintenance manuals, training, and all related and incidental work as shown in the Contact Documents, complete and accepted by the Owner.

1.06 ALLOWANCE FOR REMOVAL / RELOCATION OF EXISTING CONDUIT AND EQUIPMENT (ITEMS 2B, 3B, 4B):

- A. The allowance under this item shall be utilized as payment for work to remove or relocate existing electrical or instrumentation conduit, boxes or equipment impacted by the proposed project. Work under this allowance item shall be negotiated between the Contractor and the Owner based on the actual field conditions and the modifications required. Work under this item shall include adjustments for and direct labor costs only with a maximum profit of 5%. Indirect costs and overhead shall not be paid for separately.
- B. Payment under this allowance shall constitute full compensation for furnishing all labor, materials, tools and equipment, incidentals and constructing the modifications, complete as negotiated between the Contractor and Owner.

1.07 ITEMS 1F, 2C, 3C, 4C: GENERAL CONDITIONS:

- A. The lump sum for this item shall constitute full compensation to the Contractor for the general conditions, mobilization, demobilization, bonds and insurance, and all other work not specifically called out in other method and measurement items necessary to make the Contract operational, exclusive of the cost of materials but including furnishing and maintaining the Contractors temporary construction facilities if necessary.

END OF SECTION

SECTION 08163

FIBERGLASS REINFORCED DOOR AND DOOR FRAME SYSTEMS

PART 1 - GENERAL

1.01 WORK INCLUDED:

- A. Fiberglass Reinforced Plastic (FRP) Doors.
- B. Fiberglass Door Frames.
- C. Cylinder locks, including padlocks, shall be grand master keyed as directed by the Ownerer. Cylinders shall be removable core type. Three change keys shall be furnished with each lock, and each shall have the change number stamped thereon. Six master keys shall be furnished for each master set furnished.
- D. Construction cores shall be installed in locks for use during construction.
- E. Adequate arrangements for providing construction security without risking the integrity of the final locks will be acceptable, subject to the prior approval of the Engineer.

1.02 REFERENCES:

- A. The following standards form a part of this specification:

American Society for Testing and Materials (ASTM)

ASTM D523	Standard Test Method for Specular Gloss.
ASTM D635	Standard Test Method for Rate of Burning and/or Extent and Time of Burning of Self-Supporting Plastics in a Horizontal Position.
ASTM E84	Standard Test Method for Surface Burning Characteristics of Building Materials.
ASTM E152	Standard Methods of Fire Tests of Door Assemblies.

National Fire Protection Association (NFPA)

NFPA 252	Standard Methods of Fire Tests of Door Assemblies.
	Steel Door Institute (SDI)

SDI-100	Recommended Specifications for Steel Doors and Frames.
---------	--

Underwriters' Laboratories, Inc. (UL)

UL 10B	Standard for Fire Tests of Door Assemblies.
--------	---

- B. Where reference is made to one of the above standards, the revisions in effect at the time of bid opening shall apply.

1.03 SUBMITTALS:

- A. General: Submit in accordance with Section 01330, SUBMITTALS and this section.
- B. Product Data: Manufacturer's printed product data indicating characteristics of products specified in this Section.
- C. Shop Drawings:
 - 1. Elevations: Dimensioned elevation of door opening assembly in project; indicate size and location of door hardware.
 - 2. Details: Installation details of installation condition. Include finish hardware schedule.
- D. Selection Samples: Manufacturer's standard color chips.
- E. Verification Samples: Two (2) samples to verify color match.
- F. Manufacturer's Instructions: Printed installation instructions for door opening assemblies.

1.04 DELIVERY, STORAGE, AND HANDLING:

- A. Packing, Shipping, Handling and Unloading: Package door opening assemblies in manufacturer's standard containers.
- B. Store door assemblies in manufacturer's standard containers, on end, to prevent damage to face corners and edges.

1.05 QUALITY ASSURANCE:

- A. Standards: Comply with the requirements and recommendations in applicable specification and standards.
- B. Performance: A minimum five year record of production of frames, doors and panels and completion of similar projects in type and size within the last ten years.
- C. Instruction: The manufacturer or his representative will be available for consultation by phone to all parties engaged in the project including one day on-site instruction to installation personnel.
- D. Field Measurement: Field verify all information prior to fabrication and furnishing of materials. Furnish and install materials omitted due to lack of verification at no additional cost to the Owner.
- E. Manufacturer's Qualifications:
 - 1. Continuously engaged in manufacturing of doors of similar type to that specified, with a minimum of 25 years successful experience.

2. Door and frame components from same manufacturer.
3. Evidence of a compliant documented quality management system.

1.06 WARRANTY:

- A. Contractor's Warranty: For a period of one year from the date of substantial completion, the Contractor warrants to the Owner that FRP doors conform to these specifications and is free from defects in material and workmanship. The Contractor shall repair or replace, at the sole option of and at no cost to the Owner, any work found to be defective within said warranty period. Such repair or replacement shall include the cost of removal and reinstallation.
- B. Manufacturer's Warranty: The Contractor shall obtain from the manufacturer its warranty that (FRP Door) will be free of defects in design, materials, and workmanship for a period of 10 years following substantial completion. Said warranty, containing no exclusion or limitations, shall be in a form acceptable to, and for the benefit of, the Owner and shall be submitted by the Contractor as condition of final payment. In addition, a limited lifetime (while the door is in its specified application in its original installation) warranty covering: failure due to corrosion
 1. Warrant doors, frames, and factory hardware against failure in materials and workmanship, including excessive deflection, faulty operation, defects in hardware installation, and deterioration of finish or construction in excess of normal weathering.

PART 2 - PRODUCTS

2.01 MANUFACTURERS:

- A. Acceptable Manufacturers: FIB-R-DOR Division of Advance Fiberglass, Inc., Maumelle AR ; Corrim Company, Oshkosh, WI; Special-Lite, Inc., Decatur, MI; Commercial Door Systems, Philadelphia, PA; or equal.
- B. Requests for substitutions will be considered upon submittal of information and samples indicating the substitution will be equal or better than that specified.

2.02 MATERIALS:

- A. Fiberglass Mat: Minimum 1.5 ounces per square foot.
- B. Anchors: Manufacturer's standard stainless steel expansion anchors for existing openings.
- C. Fasteners: Stainless steel.

2.03 MANUFACTURED UNITS:

- A. Non-rated Fiberglass Reinforced Plastic (FRP) Doors:
 1. Thickness: 1-3/4-inches.
 2. Thermal Insulating Value: 'R' factor 11.
 3. Construction:

- a. Core: End-grain balsa wood, resin-impregnated.
 - b. Door Plates: Molded in one continuous piece, resin reinforced with hand-laid glass fiber mat, nominal 1/8-inch thick, minimum 15 mil gel-coated surface.
 - c. Door Edges: Minimum three (3) layers resin-reinforced glass fiber mat, nominal 3/8-inch thick, machine tooled.
- 4. Sizes: Indicated on drawings.
- 5. Finish: Smooth gloss surface, minimum value 88 in accordance with ASTM D523.
- 6. Color: As chosen by the Engineer from the manufacturer's standard colors.
- B. Non-rated Fiberglass Frames:
 - 1. Construction: One-piece pultruded fiberglass reinforced plastic, minimum 1/4-inch wall thickness, jamb-to-head joints mitered and reinforced with FRP clips and stainless steel fasteners; conforming to SDI requirements for performance equivalent to 16 gage steel frames.
 - 2. Frame profile: 5-3/4-inches deep, 2-inches wide face; double rabbeted with 5/8-inch high stop & 4-inch head for masonry openings.
 - 3. Sizes: Indicated on drawings.
 - 4. Finish: Satin finish, with true and consistent color throughout frame thickness.
 - 5. Color: As chosen by the Engineer from the manufacturer's standard colors.
- C. Frame Anchors: Types recommended by manufacturer for project conditions.
- D. Fasteners: Stainless steel screws.
- E. Door Hardware: As specified in the Contract Drawings.

2.04 FABRICATION:

- A. Fiberglass Reinforced Plastic (FRP) Doors:
 - 1. Minimum glass fiber to resin ratio: 30 percent.
 - 2. Mortise for lockset, and recess for strike plate in lock stile.
 - 3. Embed steel reinforcement for hinges in fiberglass matrix; provide for hinge leaf recesses in hinge stile.
- B. Fiberglass Frames:
 - 1. Mortise for lock strike, and recess for strike plate in lock jamb.
 - 2. Reinforce for hinges and other indicated hardware.

PART 3 - EXECUTION

3.01 EXAMINATION

A. Verification of Conditions:

1. Opening is correctly prepared to receive doors and frames.
2. Opening is correct size and depth in accordance with shop drawings.

B. Installer's Examination:

1. Have installer examine conditions under which construction activities of this section are to be performed and submit written report if conditions are unacceptable.
2. Transmit two copies of installer's report to Engineer within 24 hours of receipt.
3. Beginning construction activities of this section before unacceptable conditions have been corrected is prohibited.
4. Beginning construction activities of this section indicates installer's acceptance of conditions.

3.02 INSTALLATION:

- A. Install door opening assemblies in accordance with shop drawings, SDI-100, and manufacturer's printed installation instructions, using installation methods and materials specified in installation instructions.
- B. Installation of door hardware is specified in Section 08700 DOOR HARDWARE.
- C. Install door hardware in accordance with manufacturer's printed instructions, using through-bolts to secure surface applied hardware.
- D. Site Tolerances: Maintain plumb and level tolerances specified in manufacturer's printed installation instructions.

3.03 ADJUSTING:

- A. Adjust doors in accordance with door manufacturer's maintenance instructions to swing open and shut without binding, and to remain in place at any angle without being moved by gravitational influence.
- B. Adjust door hardware to operate correctly in accordance with hardware manufacturer's maintenance instructions.

3.04 CLEANING:

- A. Clean surfaces of door opening assemblies and sight-exposed door hardware in accordance with manufacturer's maintenance instructions.

3.05 PROTECTION OF INSTALLED PRODUCTS:

- A. Protect door opening assemblies and door hardware from damage by subsequent construction activities until final inspection.

END OF SECTION

\\\\WSE03.LOCAL\\WSE\\PROJECTS\\CT\\GNHWPCA\\2190262 NEW HAVEN HMGP\\7 BIDDING PHASE\\7.1 ADDENDA\\ADDENDUM 2\\08163 - FIBERGLASS REINFORCED DOOR AND DOOR FRAME SYSTEMS.DOCX

SECTION 08533

VINYL WINDOWS

PART 1 - GENERAL

1.01 WORK INCLUDED:

This section of the specification covers furnishing of materials, labor, fabrication, delivery and installation of Vinyl replacement windows.

1.02 REFERENCES:

A. American Architectural Manufacturers Association (AAMA):

1. AAMA/WDMA/CSA 101/I.S.2/A440-05, A440-08, and A440-11 - NAFS - North American Fenestration Standard Specification for windows, doors, and skylights.
2. AAMA 701/702 - Combined Voluntary Specifications for Pile Weather strip and Replaceable Fenestration Weather seals.
3. AAMA 902 - Voluntary Specification for Sash Balances.

B. ASTM International (ASTM):

1. ASTM E 283 - Standard Test Method for Determining the Rate of Air Leakage Through Exterior Windows, Curtain Walls and Doors Under Specified Pressure Differences Across the Specimen.
2. ASTM E 330 - Standard Test Method for Structural Performance of Exterior Windows, Curtain Walls and Doors by Uniform Static Air Pressure Difference.
3. ASTM E 547 - Standard Test Method for Water Penetration of Exterior Windows, Skylights, Doors and Curtain Walls by Cyclic Static Air Pressure Difference.
4. ASTM E 1886 - Standard Test Method for Performance of Exterior Windows, Curtain Walls, Doors, and Impact Protective Systems Impacted by Missile(s) and Exposed to Cyclic Pressure Differentials.
5. ASTM E 1996 - Standard Specification for Performance of Exterior Windows, Curtain Walls, Doors and Impact Protective Systems Impacted by Windborne Debris in Hurricanes.
6. ASTM E 2190 - Standard Specification for the Classification of the Durability of Sealed Insulating Glass Units.
7. ASTM F 588 - Standard Test Methods for Measuring the Forced Entry Resistance of Window Assemblies, Excluding Glazing Impact.

C. NFRC 100/200 - Procedures for Determining Fenestration Product U-Factors, Solar Heat Gain Coefficient (SHGc), and Visible Transmittance at Normal Incidence (VT).

1.03 SUBMITTALS:

A. Submit in under provisions of Section 01330.

B. Product Data: Submit the following documents for each type of window.

1. Manufacturer's technical data, product descriptions and installation guides.
 2. Elevation for each style window specified indicating its size, glazing type.
 3. Manufacturer's head, jamb and sill details for each window type specified.
 4. Manufacturer's standard color chart.
- C. Verification Samples: Provide operating units of each style window specified.
1. Verification samples may be operating scaled-down mock-ups of actual-size units.
 2. Operating hardware such as balances, sash locks and weather-stripping.
 3. Verification samples will be returned to manufacturer's representative at project closeout.
- D. Test Reports: Submit certified independent testing agency reports indicating window units meet or exceed specified performance requirements.

1.04 QUALITY ASSURANCE:

- A. Manufacturer Qualifications: Minimum ten years producing vinyl (PVC) windows.
- B. Installer Qualifications: Minimum 5 years' experience on projects of similar size and acceptable to window manufacturer.
- C. Source Limitations: Obtain window units from one manufacturer through a single source.
- D. Testing: Provide window units independently tested and found to be in compliance with AAMA/WDMA/CSA 101/I.S.2/A440-05, A440-08, or A440-11 performance standards.
- E. Code Compliance: Provide windows that are labeled in compliance with the jurisdiction having authority in the location of the project.

1.05 DELIVERY, STORAGE, AND HANDLING:

- A. Deliver windows to project site in undamaged condition; handle windows to prevent damage to components and to finishes.
- B. Store products in manufacturer's unopened packaging, out of direct sunlight or high temperature locations, until ready for installation.

1.06 PROJECT CONDITIONS:

- A. Maintain environmental conditions (temperature, humidity and ventilation) within limits recommended by manufacturer for optimum results. Do not install products under environmental conditions outside manufacturer's recommended limits.

1.07 WARRANTY:

- A. Submit manufacturer's standard warranty against defects in workmanship and materials.

1. Limited Lifetime Limited Transferable warranty on extruded solid vinyl member and component parts. Insulated glass is warranted against material obstruction of transparency resulting from film formation or dust collection on the interior glass surfaces for a period of twenty (20) years. Consult warranty for complete details.
2. Limited 10 Year warranty period for commercial project work such as apartments, housing authorities and other buildings not used by individual homeowners, covering all vinyl, glass and component parts. Consult warranty for complete details.

PART 2 - PRODUCTS

2.01 MANUFACTURERS:

- A. Acceptable Manufacturers: Harvey Building Products, Waltham, MA, JELD-WEN Windows and Doors, Charlotte, NC , Anderson Windows, Bayport MN, or approved equal.

2.02 REPLACEMENT DOUBLE HUNG WINDOWS:

A. Construction:

1. Vigilance Impact Resistant Window by Harvey Building Products, or approved equal.
2. Frame: Polyvinyl chloride (PVC) with miter cut and fusion welded corners.
3. Sash: shall be with miter cut and fusion welded corners.
4. Color: selected by Owner / Engineer.
5. Glazing: Insulating glass units secured to sash frame using a silicone sealant and a dual durometer glazing bead. Complies with ASTM E 2190.
6. Sash Locks: Cam type.
7. Weather stripping: In compliance with AAMA 701.2.

B. Performance:

1. Structural Rating: HS-LC35 (DP35) - Test Size: 72-inches x 62 1/2-inches in accordance with AAMA/WDMA/CSA 101/I.S.2/A440-11.
2. Forced Entry: Type A, Grade 10 in accordance with ASTM F 588.
3. Sound Transmission Class (STC): 26.
4. Thermal Transmittance: The following values are in accordance with NFRC 100/200.
 - a. Low-E No Grid: U-Factor 0.33/ R-Value 3.03/ SHGc 0.30/ VT 0.55.

PART 3 - EXECUTION

3.01 EXAMINATION:

- A. Verify rough opening size is of sufficient size to receive window unit and complies with manufacturer's requirements for opening clearances. Verify that sill plate is level.
- B. Notify Owner's designated field representative of unacceptable conditions before proceeding with installation.

3.02 INSTALLATION:

- A. Install window unit in accordance with manufacturer's printed instructions including the following:
 - 1. Apply sealant around perimeter of window unit between nail fin and exterior wall face. Refer to Division 7 Section "Joint Protection".
 - 2. Install window unit square, level and plumb. Center window unit in opening and secure window unit by screwing through jambs as indicated in manufacturer's instructions.
 - 3. Flash window in accordance with AAMA's "Standard Practice for Installation of Windows in CMU Construction".
- B. PVC Trim and extension jambs, install PVC extension jambs from window unit to flush with interior masonry wall face. Install 1-inch x 4-inch PVC trim boards in a picture frame manor around entire window perimeter interior and exterior.

3.03 ADJUSTING:

- A. Adjust units for smooth operation without binding or racking. Adjust sash locks and screens for smooth operation.

3.04 CLEANING AND PROTECTION:

- A. Clean soiled surfaces and glass prior to substantial completion.
- B. Protect window unit from damage until substantial completion. Repair or replace damaged units.

END OF SECTION

SECTION 11312

SUMP PUMPS

PART 1 - GENERAL

1.01 WORK INCLUDED:

This section specifies the furnishing and installation of submersible sump pumps.

1.02 SYSTEM DESCRIPTION:

- A. Submersible sump pump, with motor, shall be installed in proposed sump.

1.03 REFERENCES:

- A. The latest edition of the following standards form a part of this specification:

American Society for Testing and Materials (ASTM)

ASTM B221 Aluminum-Alloy Extruded Bars, Rods, Shapes and Tubes

National Electric Code (NEC)

NEC Code National Electric Code

National Electric Manufacturer's Association (NEMA)

NEMA Standard as Specified.

1.04 QUALITY ASSURANCE:

All equipment shall conform to the following criteria:

- A. Equipment shall be manufacturer's standard cataloged products, model and size, presently in commercial production. Unless otherwise specified, prototypes in model or size shall not be accepted.
- B. Conform to Hydraulic Institute Standards.
- C. All equipment specified under this Section shall be furnished by a single pump manufacturer and shall be products of manufacturers regularly engaged in the production of said equipment. The manufacturer shall have the sole responsibility for proper functioning of the complete pumping unit.

- D. Any reference to a specific manufacturer or model number is for the purpose of establishing a quality or parameter for specification writing and is not to be considered proprietary. In all cases any source or device that has the quality and operating capabilities specified may be acceptable.
- E. Conform to requirements for materials, installation and equipment approvals of state, local, Underwriter's Laboratories, Inc., or other applicable codes, whether or not called for on the drawings or in the specifications.
- F. Workmanship shall be first class in all respects.
- G. Base the use of unspecified materials on their continuous and successful employment under similar conditions, as called for in this section.

1.05 SUBMITTALS:

- A. Provide shop drawings as specified in the General Conditions and Section 01330 of the Construction Documents. Equipment Systems Manufacturers shall integrate all required shop drawings into a common package.
- B. Refer to Section 11000, Equipment General for additional information.

1.06 OPERATIONS AND MAINTENANCE MANUALS

- A. Provide operation and maintenance manuals as specified in the General Conditions and Section 01760 of the Construction Documents. Equipment Systems Manufacturers shall integrate all required manuals into a common package. One preliminary O&M manual shall be submitted for review. Upon incorporation of review comments and final approval four (4) sets of the final O&M Manual shall be provided.

1.07 GUARANTEE/WARRANTIES:

- A. The manufacturer's warranties from defects shall contain a provision that the manufacturer shall repair or replace any defects, to the satisfaction of and at no additional cost to the Owner, for any equipment provided herein, for a period of twelve (12) months from the date of substantial completion. The warranty information shall be provided in writing from the manufacturer in the submittal and shall be revised upon project completion to incorporate the date of the project completion.
- B. Refer to Section 11000, Equipment General for additional information.

1.08 DELIVERY, STORAGE AND HANDLING:

- A. The equipment, materials and spare parts shall be shipped complete and ready for installation except where partial disassembly is required by transportation regulations, is

recommended by the manufacturer, or for protection of components. The manufacturer shall recommend and confirm all storage arrangements.

B. Refer to Section 11000, Equipment General for additional information.

PART 2 - PRODUCTS

2.01 PUMPS:

- A. Provide sump pump, automatic, with 1-1/2inch discharge.
- B. Sump pumps shall be capable of discharging 19 gallons per minute at TDH of 15 feet.
- C. The sump pump motors shall be 3/10 HP, 115 Volt, 1-phase, permanent split capacitor type.
- D. The volute casings shall have feet to support the impeller entrance and to maintain the proper distance above the sump bottom.
- E. Sump pumps shall be capable of passing 1/2 inch diameter solids.
- F. Sump pump shall be cast iron, with upper sleeve bearing, lower ball bearing, carbon and ceramic mechanical seal, non-clogging vortex impeller and stainless steel hardware.
- G. Sump pumps shall be Zoeller model 63 or approved equal.

PART 3 - EXECUTION

3.01 INSTALLATION:

- A. Install sump pumps in accordance with all written instructions furnished by the manufacturer.
- B. Prior to installation, the Contractor shall clean all surfaces damaged in shipment or handling and shall touch up in the field with the same materials as the original coatings.

3.02 FIELD ACCEPTANCE TESTS:

After installation of the equipment, the Contractor shall operate each unit to demonstrate its ability to pump without excessive vibration, motor overloading, or overheating. Each pump shall be operated for a sufficient period of time to permit thorough observation of all components. All defects or defective equipment shall be corrected or replaced promptly at the Contractor's expense.

END OF SECTION

\\wse03.local\WSE\Projects\CT\GNHWPCA\2190262 New Haven HMGP\7 Bidding Phase\7.1 Addenda\Addendum 2\11312 - Sump Pumps.doc

ADDENDUM 2
ATTACHMENT

NEW BID PACKAGE

SUBMIT THIS BID PACKAGE



**Greater New Haven Water Pollution Control Authority
Protecting the Environment**

**PROJECT: NEW HAVEN PUMP STATIONS
RESILIENCY IMPROVEMENT PROJECT**

PROJECT NUMBER: SSF 2016-02/FEMA DR4087-CT-74R

**BID OPENING: 11:00 AM
Wednesday
December 18, 2019**



**GREATER NEW HAVEN
WATER POLLUTION CONTROL AUTHORITY
260 EAST STREET
NEW HAVEN, CT 06511
PHONE: 203.466.5280 FAX:203.772.2027
WEB: WWW.GNHWPCA.COM
EMAIL: ENGINEERING@GNHWPCA.COM**

EMERGENCY NUMBER: 203-466-5260

TABLE OF CONTENTS

<u>Division</u>	<u>Section Number</u>
0 BIDDING AND CONTRACT REQUIREMENTS	
Form of General Bid: Pages 00410-1 to 00410-6	00410
Bidder's Qualification Statement	00420
Listing of Proposed Subcontractors	00420
Non-Collusion Affidavit	00420
Bid Bond	00420
Statement of Bidder's Compliance with Executive Order No. 3	00420
Statement of Bidder's Compliance with Executive Order No. 16	00420
Statement of Bidder's Compliance with Executive Order No. 17	00420
State of CT DAS Contractor Prequalification Update (Bid) Statement (and Prequalification Certificate)	00420

END OF SECTION

SECTION 00410

FORM OF GENERAL BID

Proposal of _____ (hereinafter called "Bidder")*

☐ a corporation, organized and existing under the laws of the State of Connecticut

☐ a partnership

☐ a joint venture

☐ a limited liability company

☐ an individual doing business as _____

*Insert corporation, partnership, joint venture or individual as applicable.

To the Greater New Haven Water Pollution Control Authority (hereinafter called "Owner").

Gentlemen:

The Bidder, in compliance with your invitation for bids for the New Haven Pump Station Resiliency Improvements Project, having examined the plans and specifications with related documents and the site of the proposed work and being familiar with all of the conditions surrounding the construction of the proposed project including the availability of materials and labor, hereby proposes to furnish all superintendence, labor, services, materials, equipment, plant, machinery, apparatus, appliances, tools, supplies, bailing, shoring, removal, and all other things necessary to construct the project in accordance with the Contract Documents, as prepared by Weston & Sampson Engineers, Inc., within the time set forth therein and at the prices stated below. These prices are to cover all expenses incurred in performing the work required under the Contract Documents, of which this proposal is a part.

The Bidder hereby agrees to commence work under this Contract on or before a date to be fixed in the written "Notice to Proceed" given by the Owner to the Contractor and to fully complete all work related to the Contract as stated in Section 00520. The Bidder further agrees to pay as liquidated damages in accordance with Section 00520.

Bidder acknowledges receipt of the following addenda:

No.	Dated:
No.	Dated:
No.	Dated:
No.	Dated:

The Bidder agrees to perform the work described in the specifications and shown on the plans for the following lump sum prices:

All entries shall be made clearly in ink or typewritten. Amounts are to be shown in both words and figures. Discrepancies between words and figures will be resolved in favor of words. Discrepancies between the indicated total of lump sum prices multiplied by the estimated quantities and the correct total will be resolved in favor of the correct total. Discrepancies between the indicated sum of any column of figures and the correct sum thereof will be resolved in favor of the correct sum.

Bid price for Items 1A through 4H, inclusive:

_____ Dollars	
(Words)	
And _____ cents	\$ _____
(Words)	(Numbers)

The submission of the proposed price is as detailed in the following pages (excluding sales and use tax)

Company Name: _____

12/18/2019

BASE PRICE

Item No.	DESCRIPTION	UNIT PRICE (dollars in words)	UNIT PRICE (\$s)	Quantity	Unit	AMOUNT
FORT HALE PUMP STATION						
1A	Fort Hale PS Improvements		\$	1	LS	\$
1B	Test Pits		\$	50	CY	\$
1C	Allowance for Utility Company Work	twenty-five thousand	\$ 25,000.00	1	Allow	\$ 25,000.00
1D	Repair of Deteriorated or Spalled Concrete		\$	200	SF	\$
1E	Allowance for Abatement of Contaminated Materials	ten thousand	\$ 10,000.00	1	Allow	\$ 10,000.00
1F	Fort Hale PS General Conditions		\$	1	LS	\$
EAST SHORE WPAF (ESWPAF)						
2A	ESWPAF-Operations Building Improvements		\$	1	LS	\$
2B	Allowance for Removal/Relocation of Existing Conduit and Equipment	twenty-five thousand	\$ 25,000.00	1	Allow	\$ 25,000.00
2C	ESWPAF General Conditions		\$	1	LS	\$
BOULEVARD PUMP STATION						
3A	Boulevard PS Improvements		\$	1	LS	\$
3B	Allowance for Removal/Relocation of Existing Conduit and Equipment	twenty-five thousand	\$ 25,000.00	1	Allow	\$ 25,000.00
3C	Boulevard PS General Conditions		\$	1	LS	\$
EAST STREET PUMP STATION						
4A	East Street PS Improvements		\$	1	LS	\$
4B	Allowance for Removal/Relocation of Existing Conduit and Equipment	twenty-five thousand	\$ 25,000.00	1	Allow	\$ 25,000.00
4C	East Street PS General Conditions		\$	1	LS	\$
TOTAL						\$

The above bid prices shall include all labor, materials, bailing, shoring, removal, overhead, profit, insurance, etc., to cover the finished work of the several kinds called for.

The Contract will be awarded to the lowest eligible and responsible bidder on the basis of the lowest bid for the base bid for the Project.

The Bidder understands that the Owner reserves the right to reject any or all bids and to waive any informalities in the bidding.

The Bidder agrees that this bid shall be good and may not be withdrawn for a period of ninety (90) days, Saturdays, Sundays and legal holidays excluded, after the opening of bids.

Within ten (10) days of receipt of the written notice of acceptance of this bid, the Bidder will execute the formal agreement attached in Section 00520, Agreement.

Bid security is attached in the sum of ten percent (10%) of the total base bid in accordance with the conditions of Section 00200, Instructions to Bidders. The bid security may become the property of the Owner in the event the Contract and bond are not executed within the time set forth above.

The selected Contractor shall furnish a performance bond and a payment bond in an amount at least equal to one hundred percent (100%) of the contract prices in accordance with Section 00610, Performance Bond, Section 00615, Payment Bond, and as stipulated in paragraph 5.01 of Section 00700, Standard General Conditions of the Construction Contract of these specifications.

The undersigned hereby certifies that it is able to furnish labor that can work in harmony with all other elements of labor employed or to be employed in the work.

The undersigned certifies under penalties of perjury that this bid is in all respects bona fide, fair and made without collusion or fraud with any other person. As used in this paragraph the word "person" shall mean any natural person, joint venture, partnership, corporation or other business or legal entity which sells materials, equipment or supplies used in or for, or engages in the performance of, the same or similar construction, reconstruction, installation, demolition, maintenance or repair work or any part thereof.

The undersigned further certifies under penalty of perjury that the said undersigned is not presently debarred from doing public construction work in the State of Connecticut under applicable debarment provisions of the Connecticut General Statutes or any rule or regulations promulgated thereunder.

Respectfully submitted:

Date _____

By _____
(Signature)

(Name – Typed or Printed)

(Title)

(SEAL - if bid is by a corporation)

(Business Name)

(Federal ID Number)

(Business Address)

(City and State)

(Telephone Number)

(Fax Number)

SECTION 00420

BID FORM ATTACHMENTS

- Bidder's Qualification Statement
- Listing of Proposed Subcontractors
- Non-Collusion Affidavit
- Bid Bond
- Statement of Bidder's Compliance with Executive Order No. 3
- Statement of Bidder's Compliance with Executive Order No. 17
- Statement of Bidder's Compliance with Executive Order No. 16
- State of Connecticut DAS Contractor Prequalification Update (Bid) Statement (and Prequalification Certificate)

BIDDER'S QUALIFICATION STATEMENT

TO: Greater New Haven Water Pollution Control Authority
hereinafter called "Owner"

Pursuant to bidding requirements for the Work titled: New Haven Pump Station Resiliency Improvements Project

The Bidder is qualified to complete the Work as stated below:

ORGANIZATION

If your organization is a corporation, provide the following:

Date of incorporation: _____

State of incorporation: _____

President's name: _____

Vice-president's name(s): _____

Secretary's name: _____

Treasurer's name: _____

If your organization is a partnership, answer the following:

Date of organization: _____

Type of partnership: _____

Name(s) of general partner(s): _____

If your organization is individually owned, answer the following:

Date of organization: _____

Name of owner: _____

If the form of your organization is other than those listed above, describe it and name the principles:

EXPERIENCE

List the categories of work that your organization normally performs with its own forces.

Claims and Suits. (If the answer to any of the questions below is yes, please attach details.)

- No ☐ Yes ☐ Has your organization ever failed to complete any work awarded to it?
- No ☐ Yes ☐ Are there any judgements, claims, arbitration proceedings or suits pending or outstanding against your organization or its officers?
- No ☐ Yes ☐ Has your organization filed any lawsuits or requested arbitration with regard to construction contracts within the last five years?
- No ☐ Yes ☐ Within the last five years, has any officer or principal of your organization ever been an officer or principal of another organization when it failed to complete a construction contract?

On a separate sheet, list major construction projects your organization has in progress, giving the name of project, owner, engineer, contract amount, percent complete and scheduled completion date. State the total worth of work in progress and under construction.

On a separate sheet, list the major projects your organization has completed in the past five years, giving the name of the project, owner, engineer, contact information, contract amount, date of completion and percentage of the cost of the work performed with your own forces. State average annual amount of construction work performed during the past five years.

On a separate sheet, list the construction experience and present commitments of the key individuals of your organization.

Signature _____ Date _____

Printed Name _____

Title _____

LISTING OF PROPOSED SUBCONTRACTORS

Bidder intends to utilize the following subcontractors on this project:

If none, write "none" here: _____

	<i>Name, Address and Federal ID Number of Subcontractor</i>	<i>Description of Work</i>		<i>Est. Value of Work</i>
1.			\$	
2.			\$	
3.			\$	
4.			\$	
5.			\$	
6.			\$	

Submit Instrumentation & Controls Subconsultant Qualification Statement Per Section 13410-1.02D.4

NON-COLLUSION AFFIDAVIT

GREATER NEW HAVEN WATER POLLUTION CONTROL AUTHORITY:

This is to certify that in submitting this bid, BIDDER represents that this Bid is not made in the interest of or on behalf of any undisclosed person and is not submitted in conformity with any agreement or rules of any group, association, organization, or corporation; BIDDER has not directly or indirectly induced or solicited any other Bidder to submit a false or sham Bid; BIDDER has not solicited or induced any person, firm, or corporation to refrain from bidding; and BIDDER has not sought by collusion to obtain for himself any advantage over any other Bidder or over OWNER; and the BIDDER or any person in his behalf, has not agreed, connived, or colluded to produce a deceptive show of competition in the matter of the bidding or award of the referenced contract.

Signature to be by signer of Form of General Bid.

Signature

Printed Name

Title

Subscribed and sworn to before me this ____ day of _____, 201__.

Notary Public

My commission expires on: _____

BID BOND

BIDDER (Name and Address):

SURETY (Name and Address of Principal Place of Business):

OWNER (Name and Address):

BID

BID DUE DATE: _____

PROJECT (Brief Description Including Location):

BOND

BOND NUMBER: _____

DATE (Not later than Bid due date): _____

PENAL SUM: _____

(Words)

(Figures)

IN WITNESS WHEREOF, Surety and Bidder, intending to be legally bound hereby, subject to the terms printed on the reverse side hereof, do each cause this Bid Bond to be duly executed on its behalf by its authorized officer, agent, or representative.

BIDDER

SURETY

_____(Seal)

_____(Seal)

Bidder's Name and Corporate Seal

Surety's Name and Corporate Seal

By: _____

Signature and Title

By: _____

Signature and Title
(Attach Power of Attorney)

Attest: _____

Signature and Title

Attest: _____

Signature and Title

Note: (1) Above addresses are to be used for giving required notice.
(2) Any singular reference to Bidder, Surety, OWNER or other party shall be considered plural where applicable.

1. Bidder and Surety, jointly and severally, bind themselves, their heirs, executors, administrators, successors and assigns to pay to OWNER upon default of Bidder the penal sum set forth on the face of this Bond.

2. Default of Bidder shall occur upon the failure of Bidder to deliver within the time required by the Bidding Documents (or any extension thereof agreed to in writing by OWNER) the executed Agreement required by the Bidding Documents and any performance and payment Bonds required by the Bidding Documents.

3. This obligation shall be null and void if:

3.1. OWNER accepts Bidder's Bid and Bidder delivers within the time required by the Bidding Documents (or any extension thereof agreed to in writing by OWNER) the executed Agreement required by the Bidding Documents and any performance and payment Bonds required by the Bidding Documents, or

3.2. All Bids are rejected by OWNER, or

3.3. OWNER fails to issue a Notice of Award to Bidder within the time specified in the Bidding Documents (or any extension thereof agreed to in writing by Bidder and, if applicable, consented to by Surety when required by paragraph 5 hereof).

4. Payment under this Bond will be due and payable upon default by Bidder and within 30 calendar days after receipt by Bidder and Surety of written notice of default from OWNER, which notice will be given with reasonable promptness, identifying this Bond and the Project and including a statement of the amount due.

5. Surety waives notice of and any and all defenses based on or arising out of any time extension to issue Notice of Award agreed to in writing by OWNER and Bidder, provided that the total time for issuing Notice of Award including extensions shall not in the aggregate exceed 120 days from Bid due date without Surety's written consent.

6. No suit or action shall be commenced under this Bond prior to 30 calendar days after the notice of default required in paragraph 4 above is received by Bidder and Surety and in no case later than one year after Bid due date.

7. Any suit or action under this Bond shall be commenced only in a court of competent jurisdiction located in the state in which the Project is located.

8. Notices required hereunder shall be in writing and sent to Bidder and Surety at their respective addresses shown on the face of this Bond. Such notices may be sent by personal delivery, commercial courier or by United States Registered or Certified Mail, return receipt requested, postage pre-paid, and shall be deemed to be effective upon receipt by the party concerned.

9. Surety shall cause to be attached to this Bond a current and effective Power or Attorney evidencing the authority of the officer, agent or representative who executed this Bond on behalf of Surety to execute, seal and deliver such Bond and bind the Surety thereby.

10. This Bond is intended to conform to all applicable statutory requirements. Any applicable requirement of any applicable statute that has been omitted from this Bond shall be deemed to be included herein as if set forth at length. If any provision of this Bond conflicts with any applicable statute, then the provision of said statute shall govern and the remainder of this Bond that is not in conflict therewith shall continue in full force and effect.

11. The term "Bid" as used herein includes a Bid, offer or proposal as applicable.

STATEMENT OF BIDDERS COMPLIANCE WITH EXECUTIVE ORDER NO. 3

This statement must be completed by the Bidder and shall accompany his bid for this project.

IT IS HEREBY CERTIFIED THAT:

NAME OF BIDDER _____

BUSINESS ADDRESS _____

PLEASE CHECK THE APPROPRIATE LINE

Has _____ has not _____ previously performed work under the conditions of the Governor's Executive Order No. 3 of the State of Connecticut, or any preceding similar Executive Order with regards to Non-Discrimination.

Signature

Title

Date

IMPORTANT: THIS STATEMENT MUST BE SUBMITTED WITH BID

Connecticut general statutes require nondiscrimination clauses in state contracts and subcontracts for construction on public buildings, other public works and goods and services. Henceforth all state contracts and subcontracts for construction on public buildings, other public works and goods and services shall contain a provision rendering such contract or subcontract subject to this Order, and that such contract or subcontract may be canceled, terminated or suspended by the labor commissioner for violation of or noncompliance with this Order or state or federal laws concerning nondiscrimination. Each contractor having a contract containing the provisions prescribed in section 4-114a of the 1969 supplement to the general statutes, shall file, and shall cause each of his subcontractors to file, compliance reports with the contracting agency or the labor commissioner.

STATEMENT OF BIDDERS COMPLIANCE WITH EXECUTIVE ORDER NO. 17

This statement must be completed by the Bidder and shall accompany his bid for this project.

IT IS HEREBY CERTIFIED THAT:

NAME OF BIDDER _____

BUSINESS ADDRESS _____

PLEASE CHECK THE APPROPRIATE LINE

Has _____ has not _____ previously performed work under the conditions of the Governor's Executive Order No. 17 of the State of Connecticut, or any preceding similar Executive Order with regards to Non-Discrimination.

Signature

Title

Date

IMPORTANT: THIS STATEMENT MUST BE SUBMITTED WITH BID

Connecticut general statutes require nondiscrimination clauses in state contracts and subcontracts for construction on public buildings, other public works and goods and services. Henceforth all state contracts and subcontracts for construction on public buildings, other public works and goods and services shall contain a provision rendering such contract or subcontract subject to this Order, and that such contract or subcontract may be canceled, terminated or suspended by the labor commissioner for violation of or noncompliance with this Order or state or federal laws concerning nondiscrimination. Each contractor having a contract containing the provisions prescribed in section 4-114a of the 1969 supplement to the general statutes, shall file, and shall cause each of his subcontractors to file, compliance reports with the contracting agency or the labor commissioner.

STATEMENT OF BIDDERS COMPLIANCE WITH EXECUTIVE ORDER NO. 16

This statement must be completed by the Bidder and shall accompany his bid for this project.

IT IS HEREBY CERTIFIED THAT:

NAME OF BIDDER _____

BUSINESS ADDRESS _____

Complies with the State of Connecticut Violence in the Workplace Prevention Policy as outlined in Executive Order No. 16.

Signature

Title

Date

State of Connecticut
Department of Administrative Services (DAS) Contractor Prequalification
Update (Bid) Statement
(Statement to be included with the bid)

Connecticut General Statute §4a-100 and Connecticut General Statute §4b-91

Each bid submitted for a contract shall include a copy of a prequalification certificate issued by the Commissioner of Administrative Services. The bid shall also be accompanied by an **update bid statement** in such form as the Commissioner of Administrative Services prescribes. The form for such **update bid statement** shall provide space for information regarding all projects completed by the bidder since the date the bidder's prequalification certificate was issued or renewed, all projects the bidder currently has under contract, including the percentage of work on such projects not completed, the names and qualifications of the personnel who will have supervisory responsibility for the performance of the contract, any significant changes in the bidder's financial position or corporate structure since the date the certificate was issued or renewed, any change in the contractor's qualification status, and such other relevant information as the Commissioner of Administrative Services prescribes. Any bid submitted without a copy of the prequalification certificate and an **update bid statement** shall be invalid. Any public agency that accepts a bid submitted without a copy of such prequalification certificate and an **update bid statement**, as required by this section, may become ineligible for the receipt of funds related to such bid.

Name of Project that company is bidding on:		
Project Number:		
Name of Company:		
FEIN:		
Company Address:		
Prequalification Contact:		Telephone Number:
Date of Prequalification with the DAS:	Single Limit:	Aggregate Work Capacity (AWC):
* This amount equals your company's AWC minus the Total \$ Amount of Work Remaining.		* Remaining Aggregate Work Capacity:

Please list all of your company's BONDED PROJECTS (BOTH PUBLIC AND PRIVATE) WHICH WERE 100% COMPLETED SINCE THE DATE YOUR PREQUALIFICATION WAS ISSUED OR RENEWED: (Please add additional page(s) if required)

Name of Project	Owner of Project	Date Project Completed	Total Contract Amount

Please list all of your company's BONDED PROJECTS (BOTH PUBLIC AND PRIVATE) CURRENTLY UNDER CONTRACT:
(Please add additional page(s) if required. Please total the Work Remaining column)

Name of Project	Owner of Project	Total Contract Amount	% Complete	Work Remaining (\$)
Total \$ Amount of Work Remaining →				

Please list the names and titles of the personnel who will have supervisory responsibility for the performance of the contract being bid on:
(Please add additional page(s) if required)

Individual Name	Title of Individual

Have there been any changes in your company's financial condition or business organization, which might affect your company's ability to successfully complete this contract?

Yes ☐ No ☐

If yes, please explain:

I certify under penalty of law that all of the information contained in this Update (Bid) Statement is true and accurate to the best of my knowledge as of the date below.

Signature

Date

It is the responsibility of the Awarding Authority to determine if any of the information provided above will impact the contractor's performance on this project.
The DAS' Contractor Prequalification Program can be reached at (860) 713-5280